

Property Division Map

Village
of
Footville

T. 3 N. - R. 11 E.
Section 05 NENE

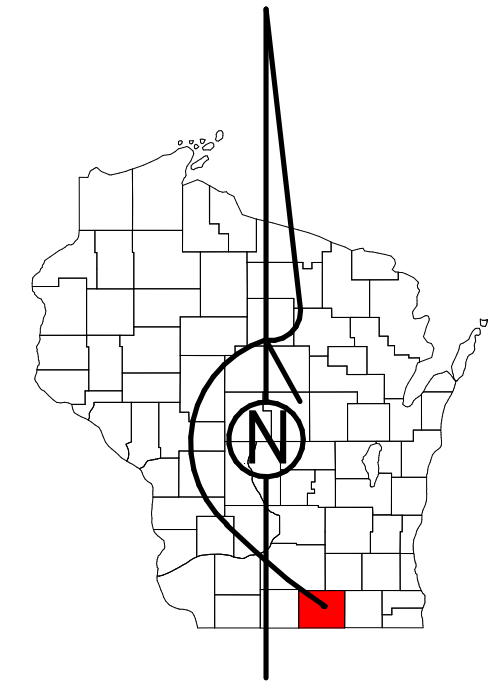

STATE OF WISCONSIN
COUNTY OF ROCK

PREPARED BY

**REAL PROPERTY DESCRIPTION
DEPARTMENT**
USING
**ROCK COUNTY
GEOGRAPHIC INFORMATION SYSTEM**

DUPPLICATION OF THIS MAP PROHIBITED
WITHOUT THE WRITTEN CONSENT OF THE
REAL PROPERTY DESCRIPTION DEPARTMENT.

THIS MAP WAS PREPARED PURSUANT
TO SECTION 70.09 WIS. STATS.
USING PUBLIC RECORDS. IT IS NOT INTENDED
TO BE A SUBSTITUTE FOR AN
ACTUAL FIELD SURVEY
AND IS ADVISORY ONLY.

DISTANCES SHOWN ON THIS
MAP WERE PRODUCED BY
THE GIS SYSTEM AND ARE
FOR REFERENCE ONLY.
SEE DOCUMENT OF RECORD
FOR ACTUAL DISTANCE.



- | | | | |
|--|------------------|--|--------------|
| | Gap | | MFL |
| | Overlap | | dam |
| | Town of Center | | easement |
| | Town of Plymouth | | hydro |
| | CSM | | lots |
| | CSMHYDRO | | parcels |
| | CSMLOT | | parcelshydro |
| | CSMLOTHYDRO | | roadrw |

See Pages

January 1, 2019

05 NENE

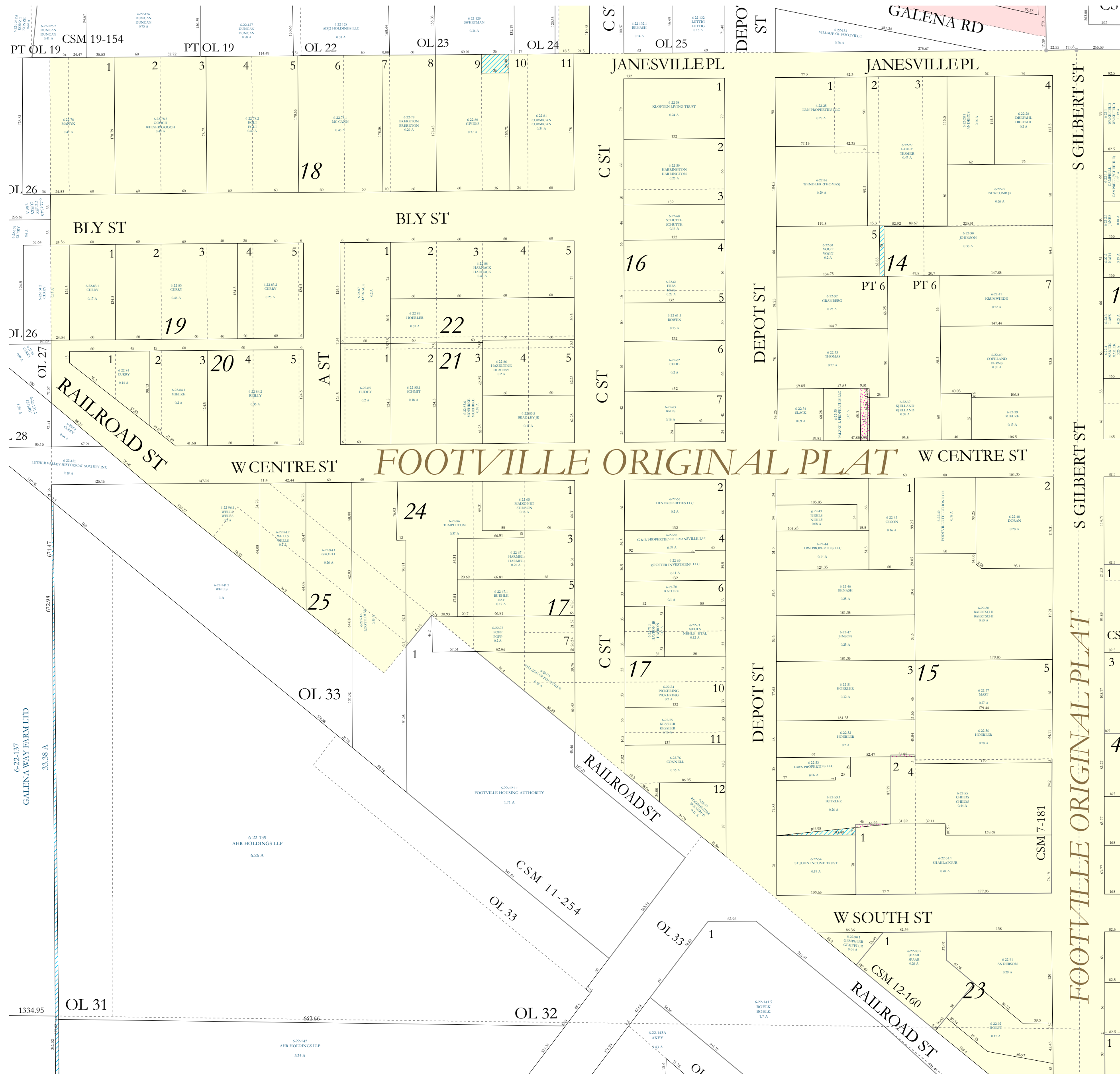

FOOTVILLE ORIGINAL PLAT

FOOTVILLE ORIGINAL PLAT

6-22-137
GALENA WAY FARM LTD
33.38 A

6-22-139
AHR HOLDINGS LLP
6.26 A

6-22-142
AHR HOLDINGS LLP
3.34 A

6-22-123
FOOTVILLE HOUSING AUTHORITY
17.1 A

6-22-145
ROBEK
ROBEK
1.7 A

6-22-146
COMPILER
COMPILER
0.8 A

6-22-147
COMPILER
COMPILER
0.8 A

6-22-148
COMPILER
COMPILER
0.8 A

6-22-149
COMPILER
COMPILER
0.8 A

6-22-150
COMPILER
COMPILER
0.8 A

6-22-151
COMPILER
COMPILER
0.8 A

6-22-152
COMPILER
COMPILER
0.8 A

6-22-153
COMPILER
COMPILER
0.8 A

6-22-154
COMPILER
COMPILER
0.8 A

6-22-155
COMPILER
COMPILER
0.8 A

6-22-156
COMPILER
COMPILER
0.8 A

6-22-157
COMPILER
COMPILER
0.8 A

6-22-158
COMPILER
COMPILER
0.8 A

6-22-159
COMPILER
COMPILER
0.8 A

6-22-160
COMPILER
COMPILER
0.8 A

6-22-161
COMPILER
COMPILER
0.8 A

6-22-162
COMPILER
COMPILER
0.8 A

6-22-163
COMPILER
COMPILER
0.8 A

6-22-164
COMPILER
COMPILER
0.8 A

6-22-165
COMPILER
COMPILER
0.8 A

6-22-166
COMPILER
COMPILER
0.8 A