

Town of Center

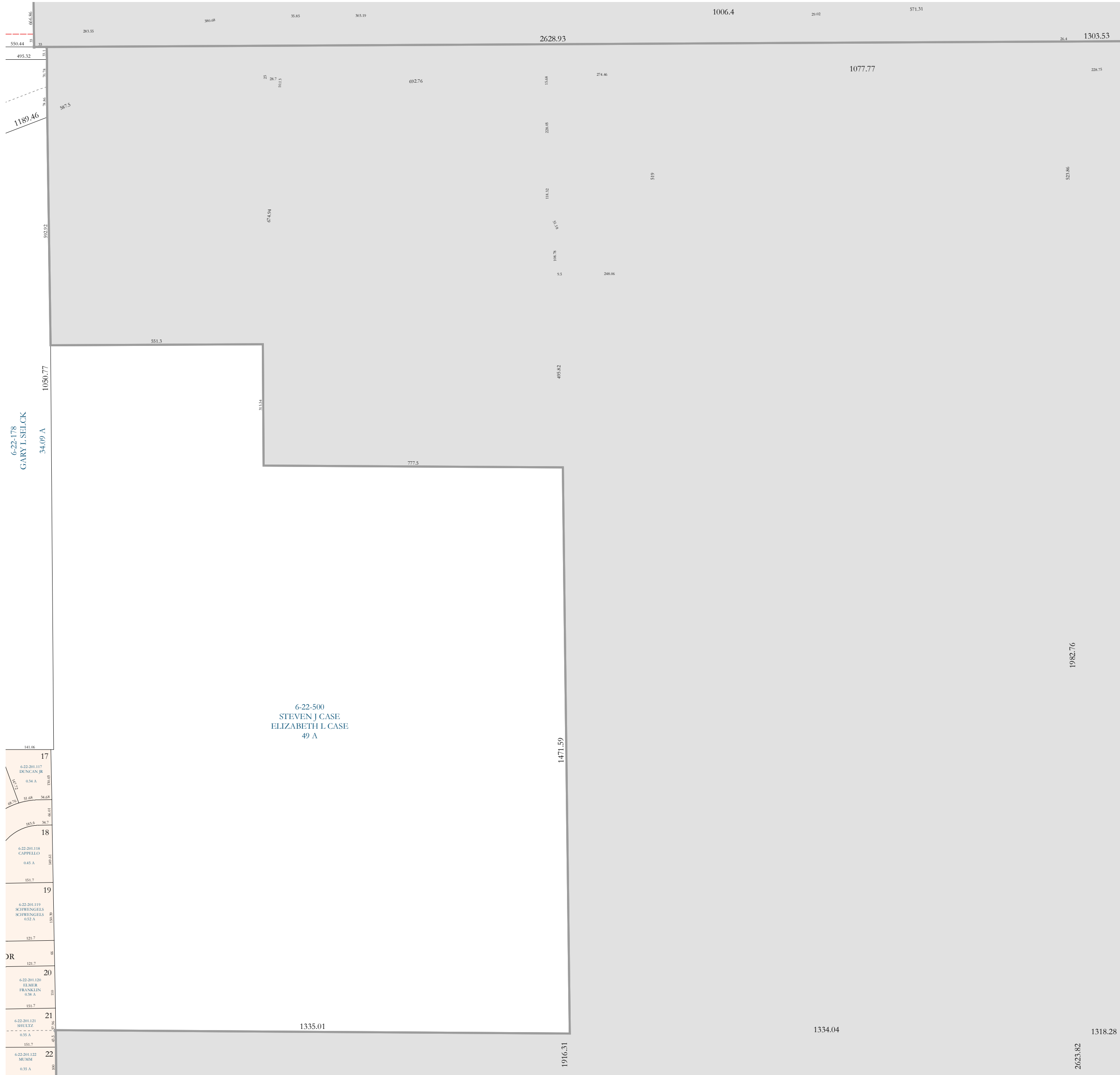

AIN #0

Town of Plymouth

Town of Plymouth

# Property Division Map

## Village of Footville

### T. 3 N. - R. 11 E.

### Section 04 NE

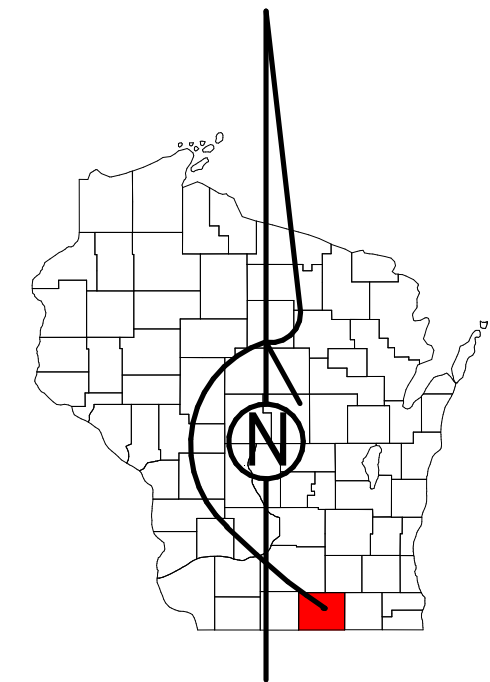

STATE OF WISCONSIN  
COUNTY OF ROCK

PREPARED BY

### REAL PROPERTY DESCRIPTION DEPARTMENT

USING













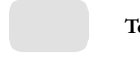

### ROCK COUNTY GEOGRAPHIC INFORMATION SYSTEM

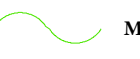
DUPLICATION OF THIS MAP PROHIBITED  
WITHOUT THE WRITTEN CONSENT OF THE  
REAL PROPERTY DESCRIPTION DEPARTMENT.

THIS MAP WAS PREPARED PURSUANT  
TO SECTION 70.09 WIS. STATS.  
USING PUBLIC RECORDS. IT IS NOT INTENDED  
TO BE A SUBSTITUTE FOR AN  
ACTUAL FIELD SURVEY  
AND IS ADVISORY ONLY.

DISTANCES SHOWN ON THIS  
MAP WERE PRODUCED BY  
THE GIS SYSTEM AND ARE  
FOR REFERENCE ONLY.  
SEE DOCUMENT OF RECORD  
FOR ACTUAL DISTANCE.

0 25 50 100 150 200  
Feet

-  Gap
-  Overlap
-  Town of Center
-  Town of Plymouth
-  CSM
-  CSMHYDRO
-  CSMLOT
-  CSMLOTHYDRO
-  MFL
-  dam
-  easement
-  hydro
-  lots
-  parcels
-  parcelshydro
-  roadrw

See Pages

January 1, 2019

# 04 NE