

6-16-16
WALTER EDWARDS, JR.
ELIZABETH EDWARDS
64.62 A

2216.11

Yabara River

6-6-287B
COUNTY OF ROCK
27.48 A

6-6-287A
COUNTY OF ROCK
12.16 A

FULTON STREET

N FULTON ST

W MAIN ST

W HARRISON ST

N CITY TRK H

CITY TRK H

CAWKER'S BLOCK

VILLAGE OF FULTON

VACATED HARRISON ST.

6-6-993.2
0.1 A

6-6-296A
MATTHEW P REILLY
26.58 A

Property Division Map

Town
of
Fulton

T. 4 N. - R. 12 E.

Section 18 NWSW

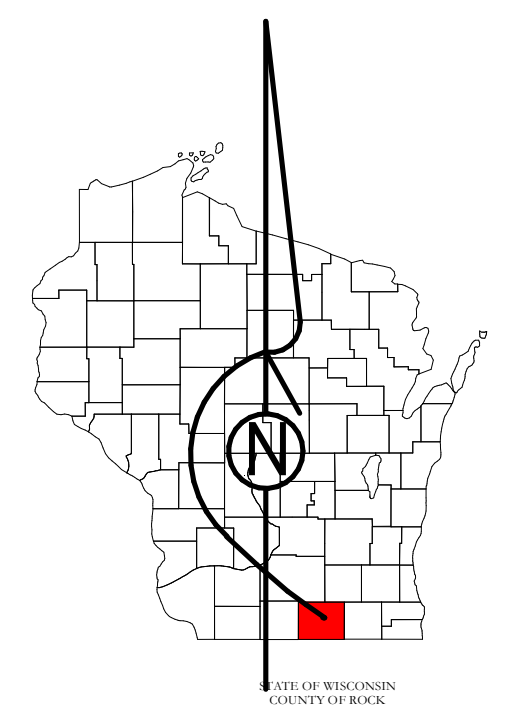

PREPARED BY

REAL PROPERTY DESCRIPTION
DEPARTMENT

USING
ROCK COUNTY
GEOGRAPHIC INFORMATION SYSTEM

DUPLICATION OF THIS MAP PROHIBITED
WITHOUT THE WRITTEN CONSENT OF THE
REAL PROPERTY DESCRIPTION DEPARTMENT.

THIS MAP WAS PREPARED PURSUANT
TO SECTION 70.09 WIS. STATS.
USING PUBLIC RECORDS. IT IS NOT INTENDED
TO BE A SUBSTITUTE FOR AN
ACTUAL FIELD SURVEY
AND IS ADVISORY ONLY.

DISTANCES SHOWN ON THIS
MAP WERE PRODUCED BY
THE GIS SYSTEM AND ARE
FOR REFERENCE ONLY.
SEE DOCUMENT OF RECORD
FOR ACTUAL DISTANCE.

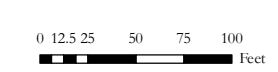

- Gap
- Overlap
- City of Edgerton
- CSM
- CSMHYDRO
- CSMLOT
- CSMLOTHYDRO
- MFL
- dam
- easement
- hydro
- lots
- parcels
- parcelshydro
- roadrw

See Pages

January 1, 2019