

PLAT AND RECORD

Of a Survey on Section 6 T 1 R 13 E. of the 4 P. M. in Turtle Township
Rock County, Wisconsin, made Nov. the 1882

I hereby certify that the following is a correct record of said survey as made by me.

COUNTY BUILDING
IN CITY OF BELOIT

(Signed) S. F. Holmes.
RCHB

County Surveyor.

Sec. 6 Turtle

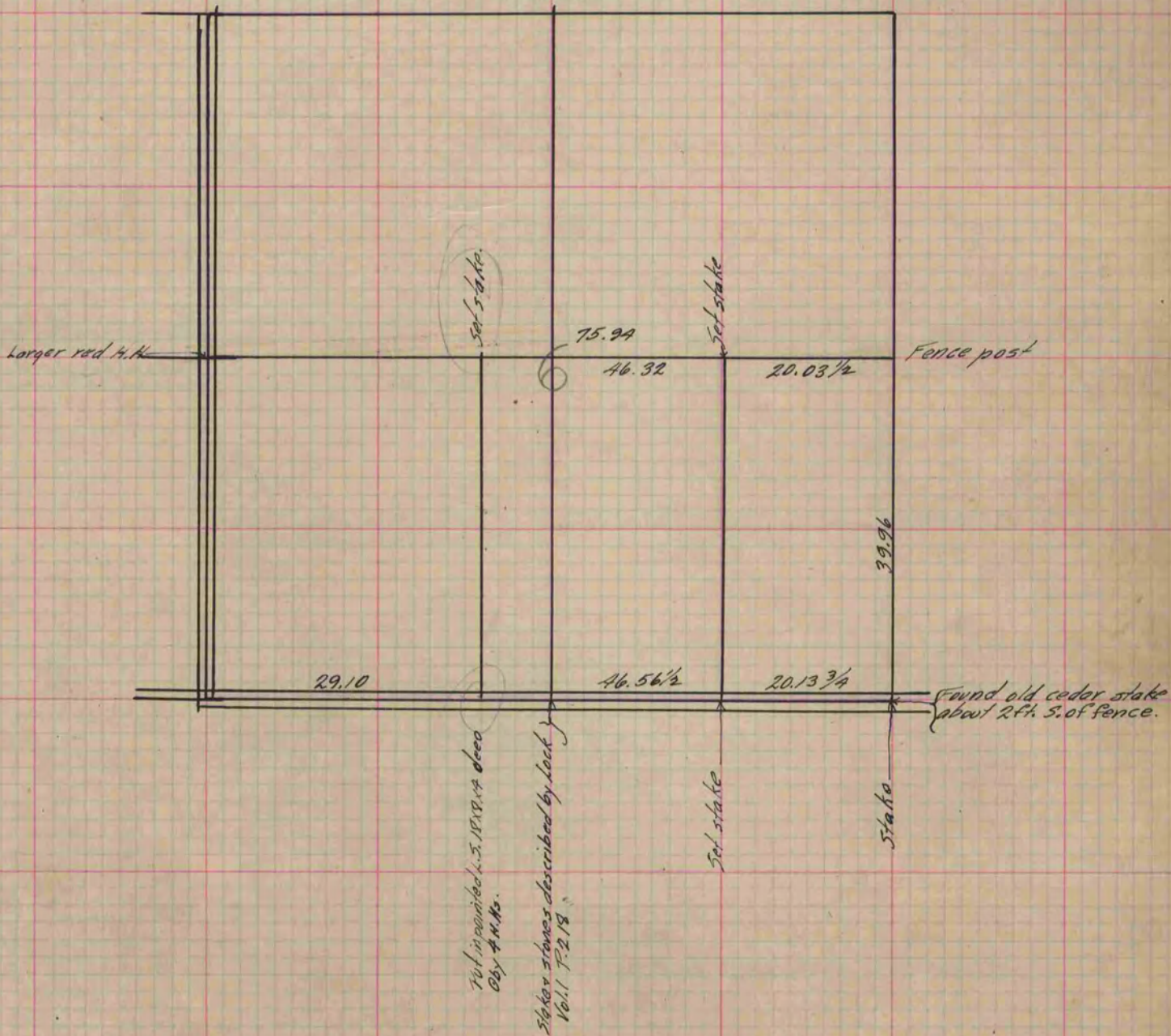

Copied From P. 287 Vol. 2 County Surveyors Record.