

PLAT AND RECORD

Of a Survey on Section 12 T 4 R 11 E. of the 4 P. M. in Porter Township

Rock County, Wisconsin, made November the 8-19 1871

I hereby certify that the following is a correct record of said survey as made by me.

COUNTY BUILDING
IN CITY OF БЕЛОIT

(Signed) Edward Ruger

County Surveyor.

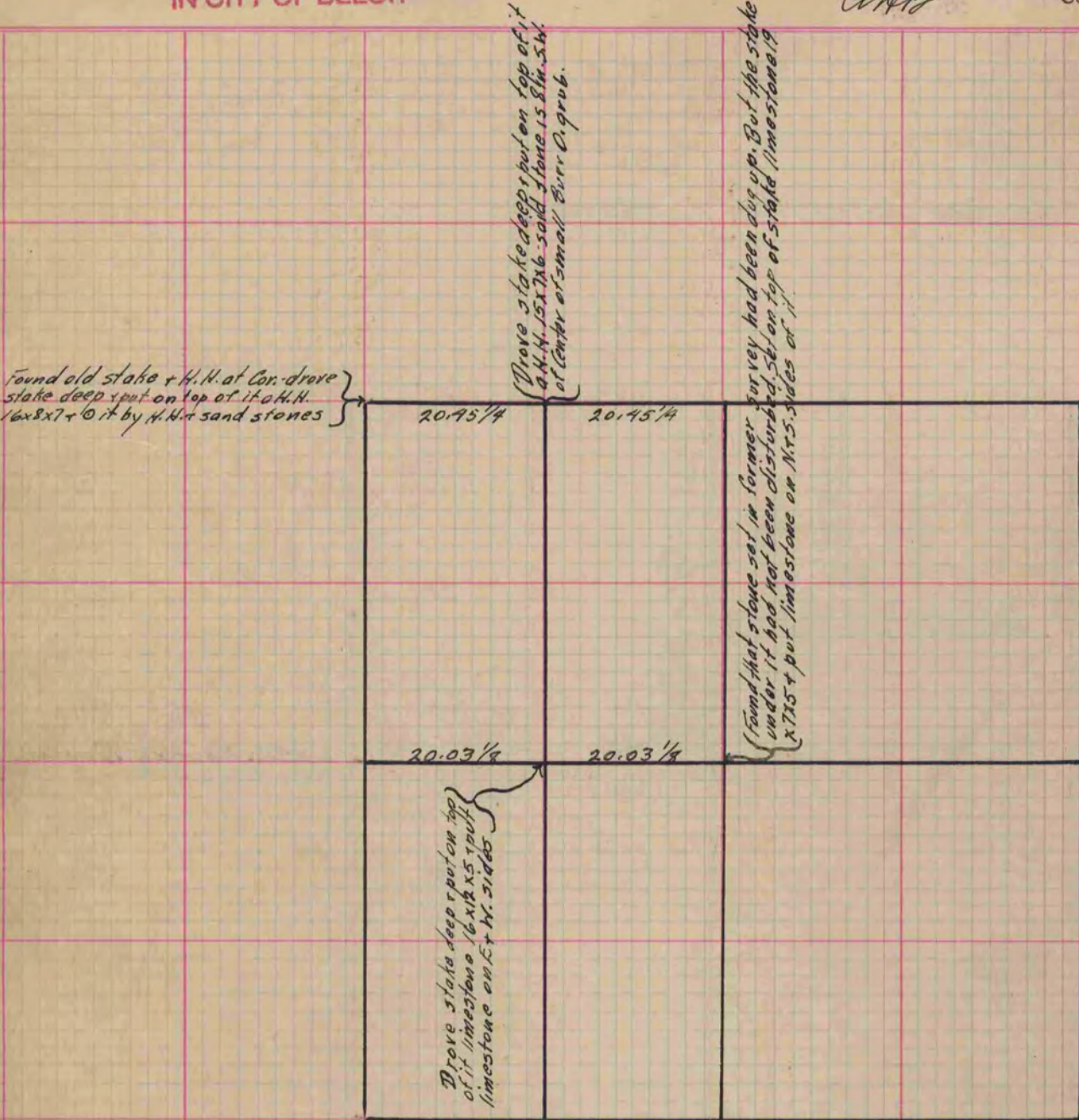

See Sec. 12 Porter Page 39

Copied from Page 46 Vol. 2 Original County Surveyor's Record.