

PLAT AND RECORD

510

Of a Survey on ^{5 1/2} Section 21 T A R 14 E. of the 4 P. M. in Lima Township
Rock County, Wisconsin, made Oct. the 1 1900

I hereby certify that the following is a correct record of said survey as made by me.

COUNTY BUILDING
IN CITY OF БЕЛОIT

(Signed) P. F. Brown
PMB

County Surveyor.

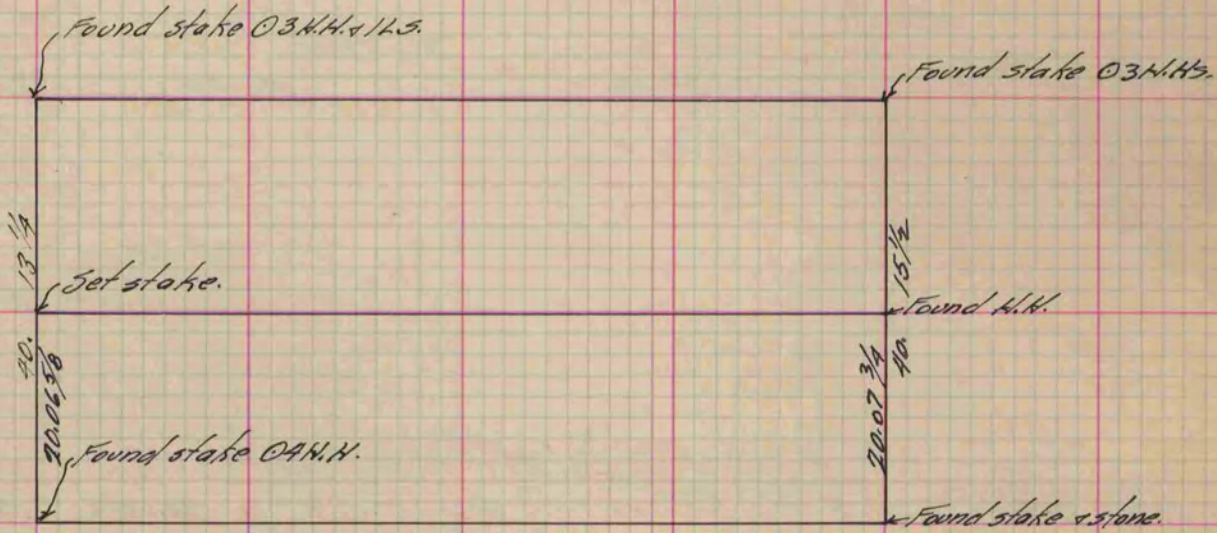

Copied from P. 392 Vol. 2 County Surveyors Record.