

PLAT AND RECORD

Of a Survey on Section 5 T 4 R 11 E. of the 4 P. M. in PORTER Township

Rock County, Wisconsin, made the 1962

I hereby certify that the following is a correct record of said survey as made by me.

**COUNTY BUILDING
IN CITY OF BELOIT**

R. B. Batteman

County Surveyor.

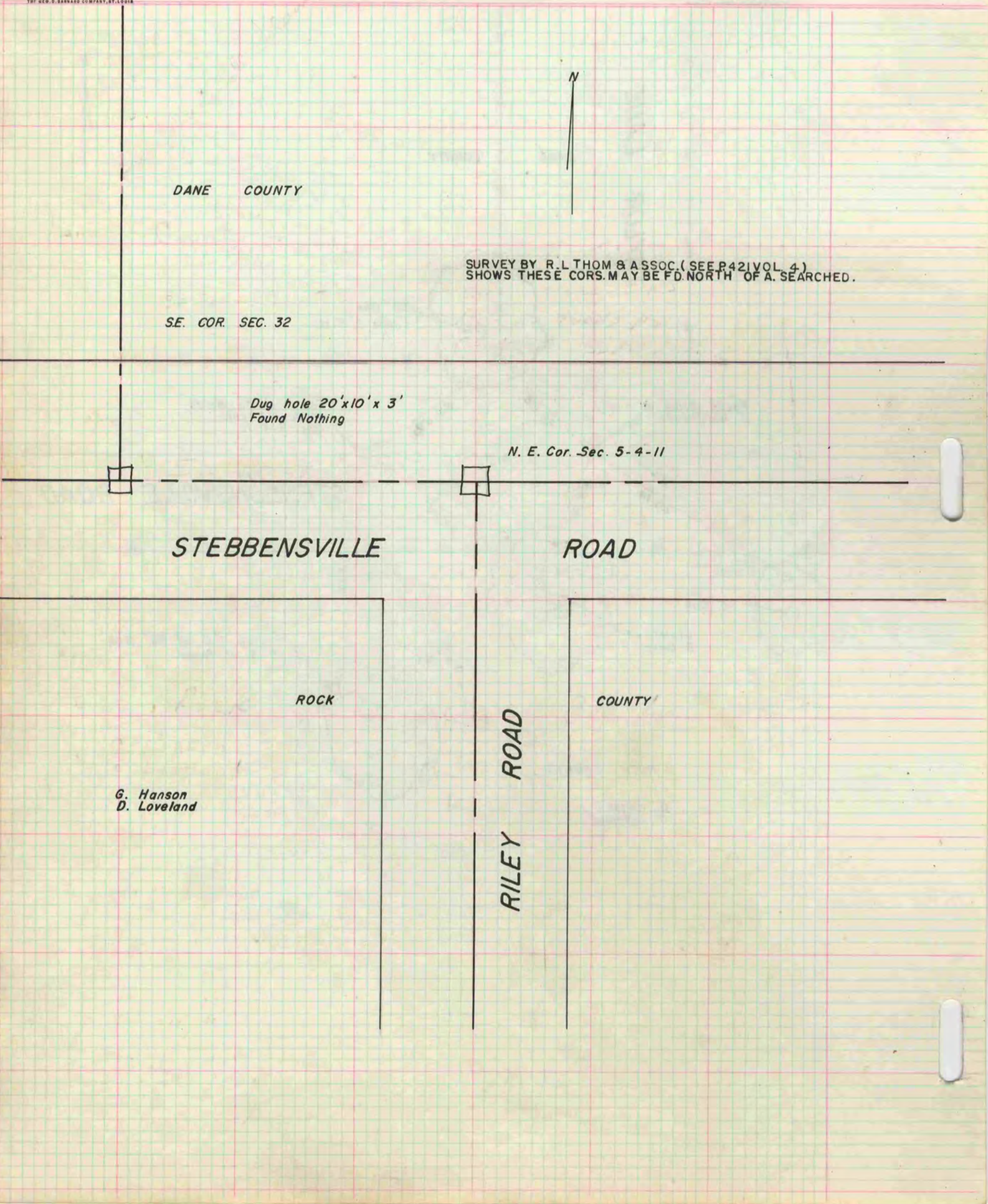

DANE COUNTY

SURVEY BY R. L. THOM & ASSOC. (SEE P. 42 VOL. 4)
SHOWS THESE CORNS. MAY BE FD. NORTH OF A. SEARCHED.

SE. COR. SEC. 32

Dug hole 20' x 10' x 3'
Found Nothing

N. E. Cor. Sec. 5-4-11

STEBBENSVILLE

ROAD

ROCK

COUNTY

G. Hanson
D. Loveland

RILEY ROAD