

MICROFILMED PLAT AND RECORD

471
V-2

COUNTY BUILDING
CITY OF JANESVILLE

Of a Survey on Section 11 T 4 R 13 E. of the 4 P. M. in Milton Township

Rock County, Wisconsin, made Oct. the 13 1892

I hereby certify that the following is a correct record of said survey as made by me.

(Signed) O.G. Bleedorn
R.H.B. County Surveyor.

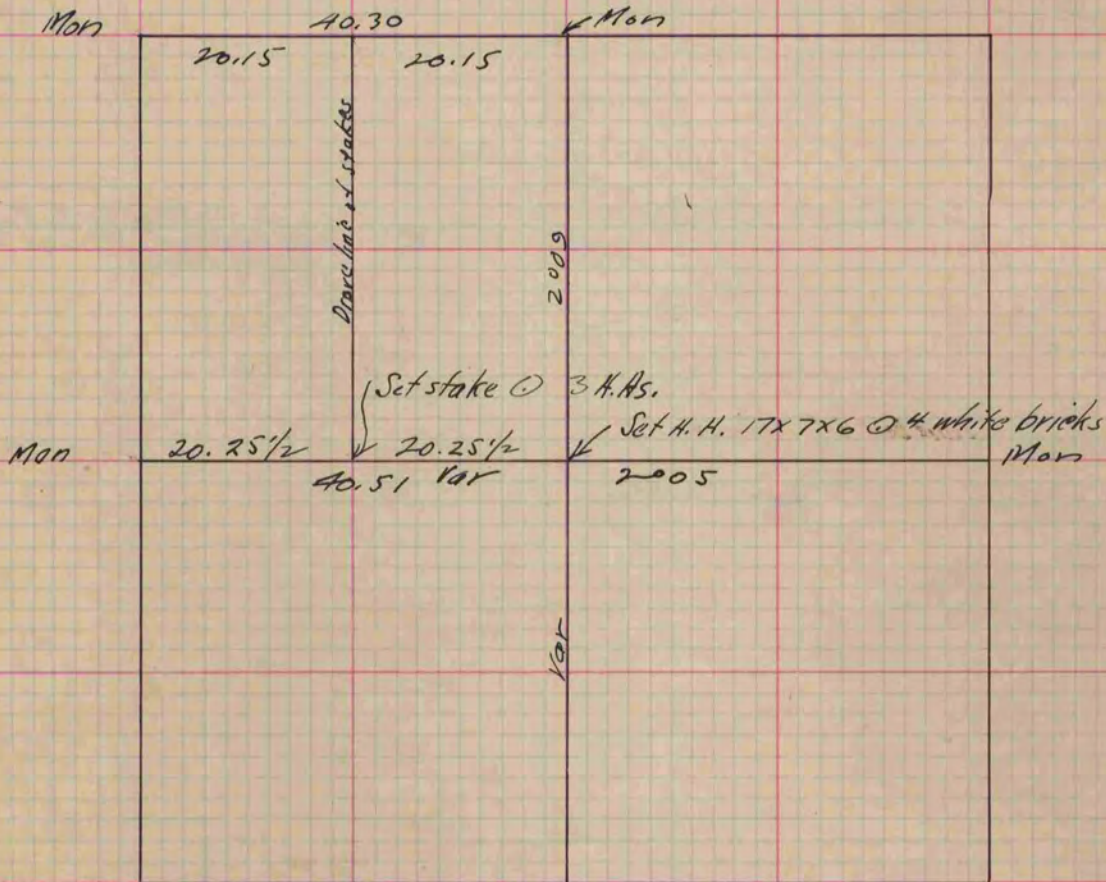

Copied from P. 369 Vol. 2. County Surveyors Record.