

**MICROFILMED**

# PLAT AND RECORD

COUNTY BUILDING  
CITY OF JANESVILLE

Of a Survey on Section 13 T 2 R 10 E. of the 4 P. M. in Spring Valley Township

Rock County, Wisconsin, made May the 13 1890

I hereby certify that the following is a correct record of said survey as made by me.

(Signed) O. G. Bleedorn Dep.  
R. H. B. County Surveyor.

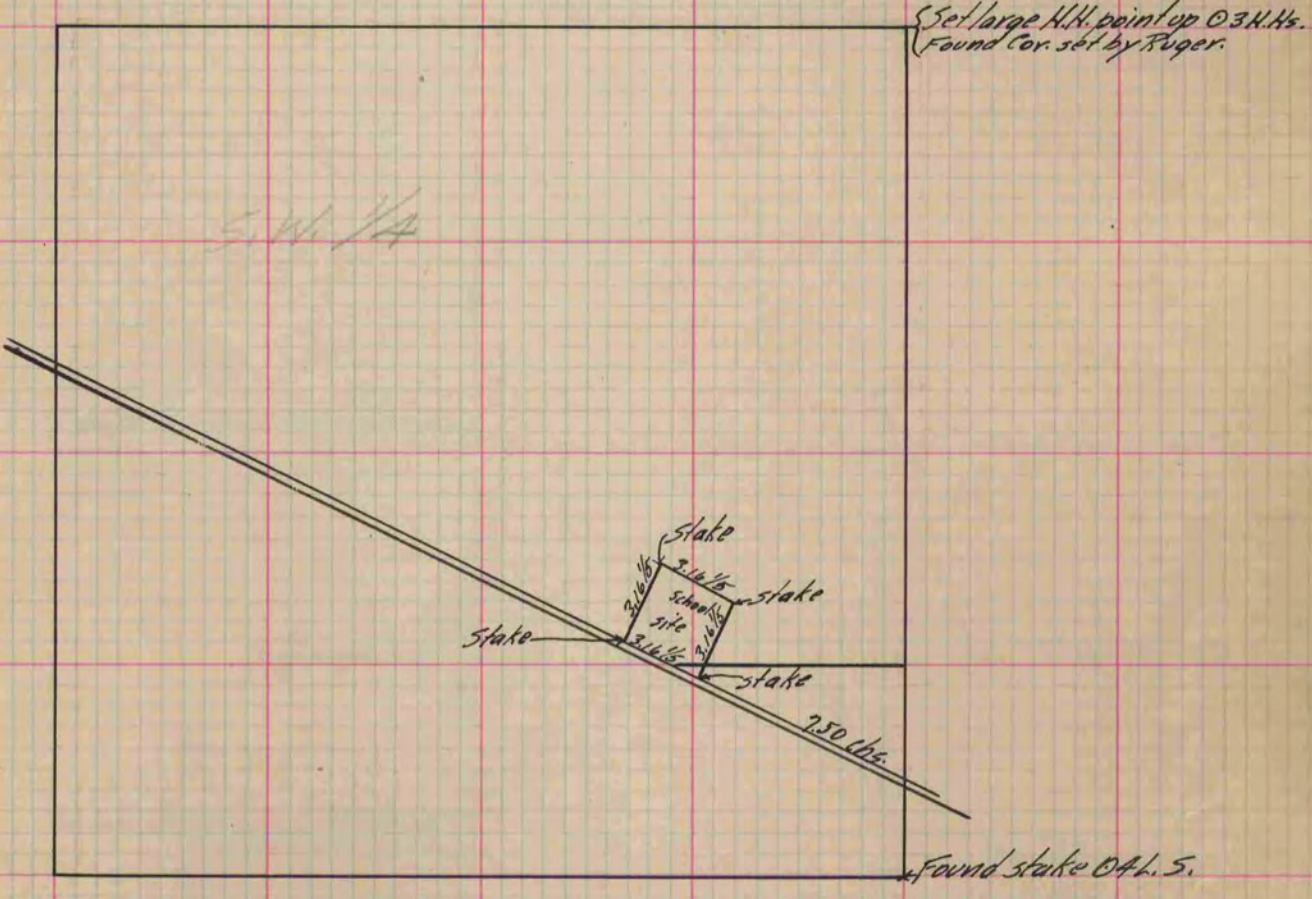

*Copied from P. 348 Vol. 2 County Surveyor's Record.*