

# PLAT AND RECORD VOL. 5

299

Of a Survey on Section 17 T 1 N R 10 E. of the 4 P. M. in - AVON Township  
Rock County, Wisconsin, made JULY 14 1977

I hereby certify that the following is a correct record of said survey as made by me.  
**COUNTY BUILDING  
CITY OF JANESVILLE**



E 1/4 cor sec 17-1-10  
fd C.I. mon

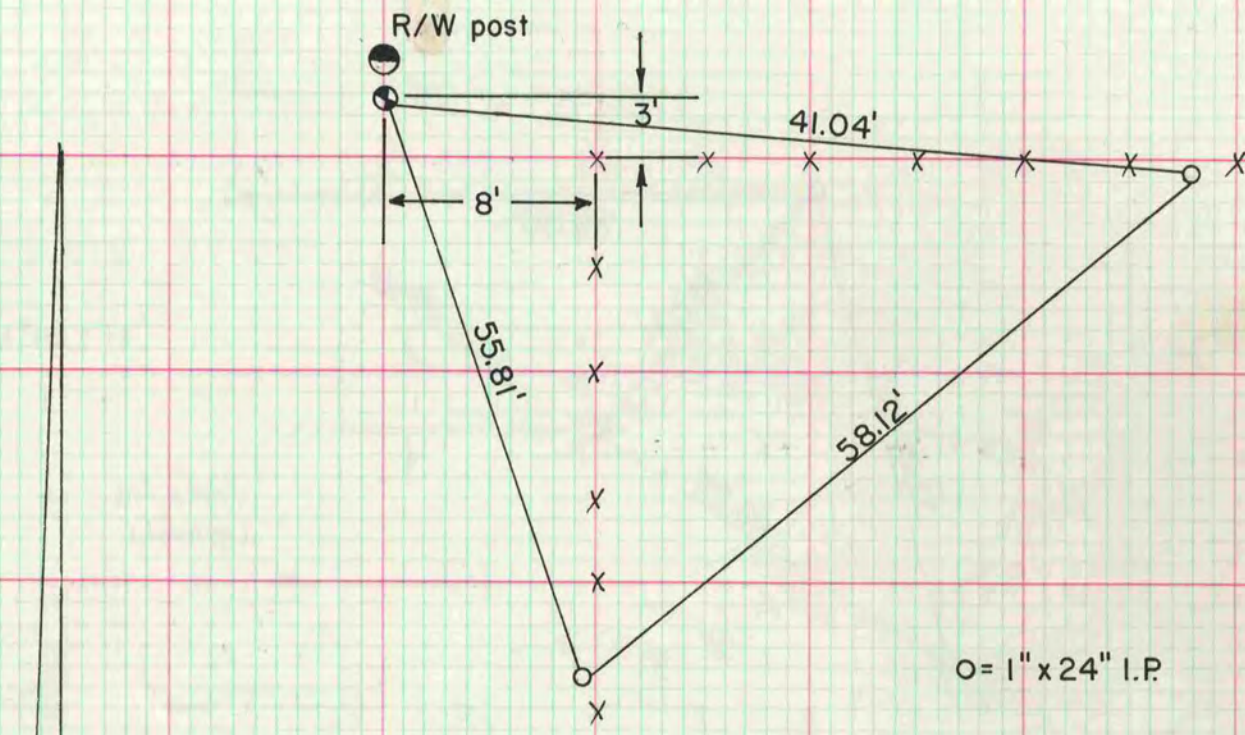

W 1/4 cor sec 17-1-10  
dug fd nothing, set alum mon. at single  
proportionate distance on line with NW  
and SW cors of sec 17

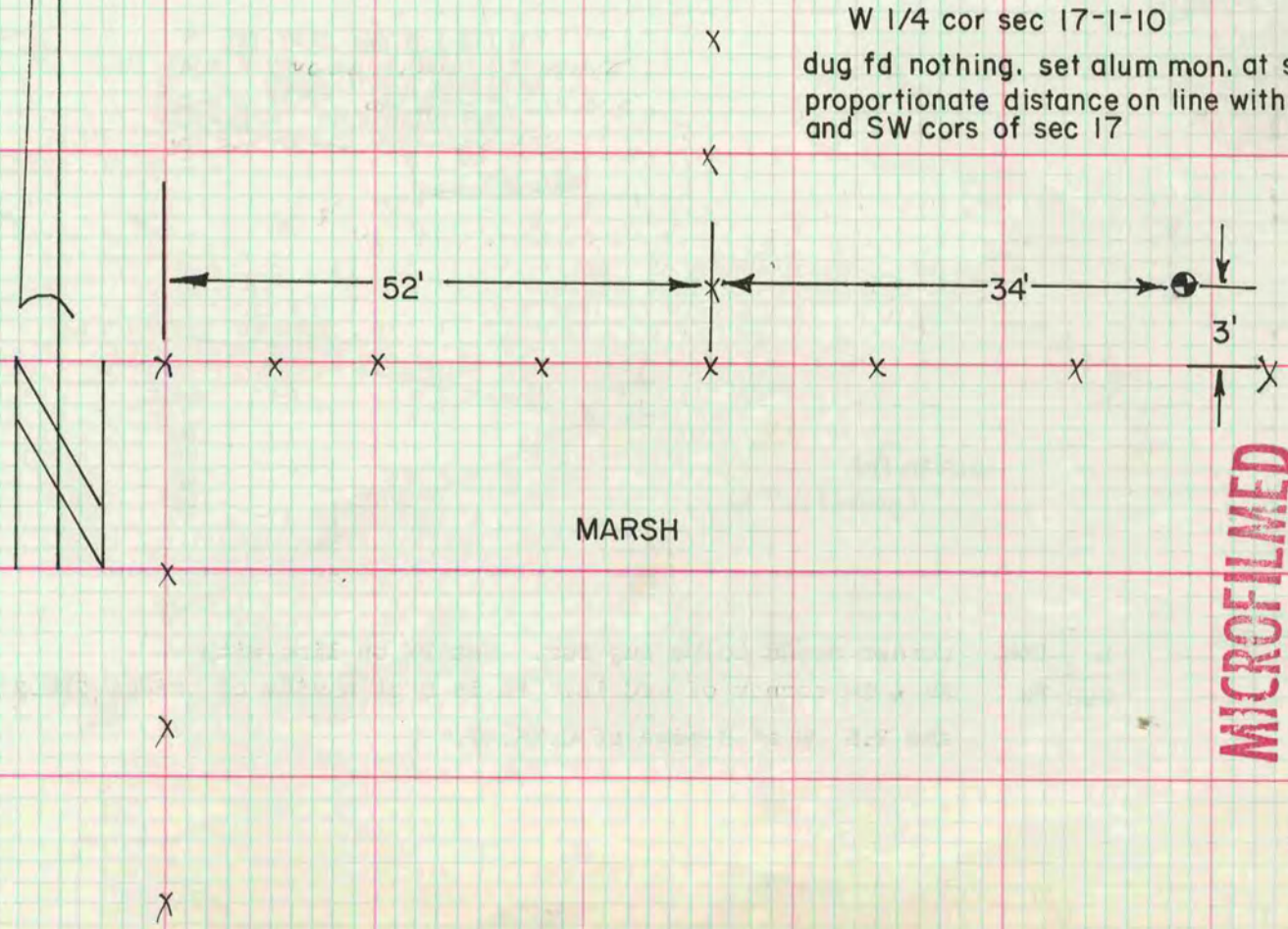

MICROFILMED