

PLAT AND RECORD

COUNTY BUILDING
CITY OF JANESVILLE

Of a Survey on Section ¹²/₃ T ¹/₁ R ¹³/₁₄ E. of the 4 P. M. in TURTLE Township
CLINTON

Rock County, Wisconsin, made the _____ 19 _____

I hereby certify that the following is a correct record of said survey as made by me.

MICROFILMED

County Surveyor.

N ¹/₄ COR SEC 12 TURTLE TWP.

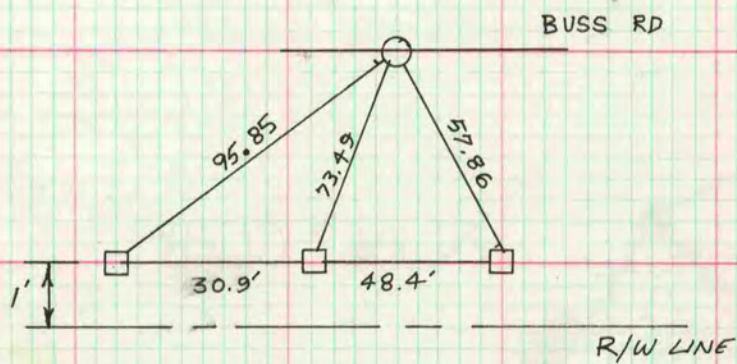

information supplied by State Hwy Dept.

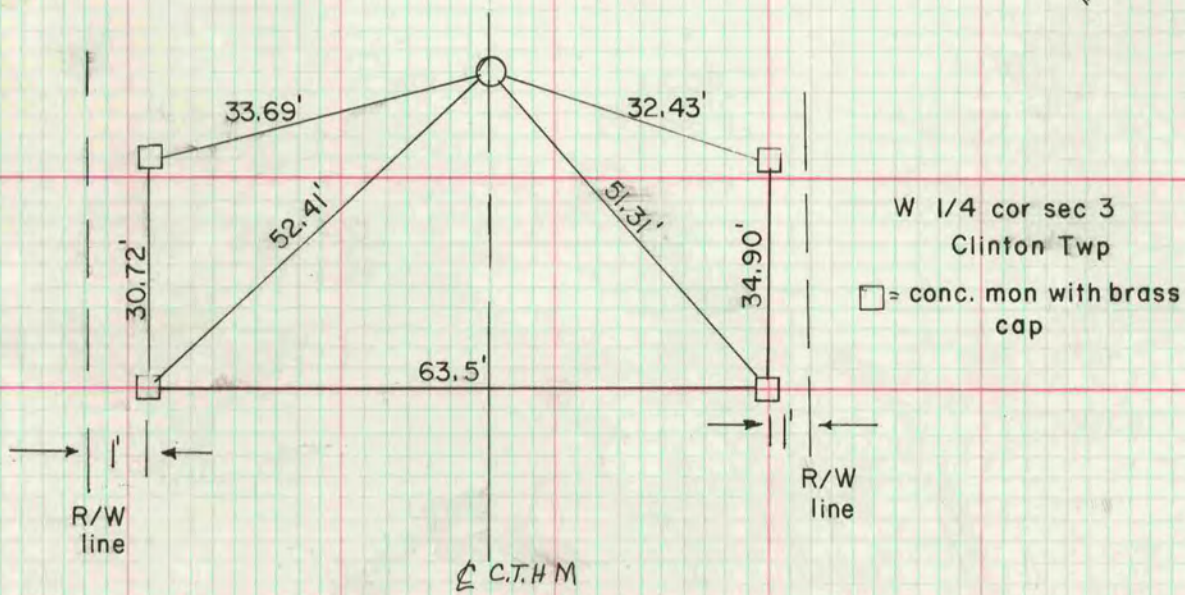

W 1/4 cor sec 3
Clinton Twp

□ = conc. mon. with brass cap

W 1/4 sec 2 Clinton Twp
information supplied by
State Hwy Dept.

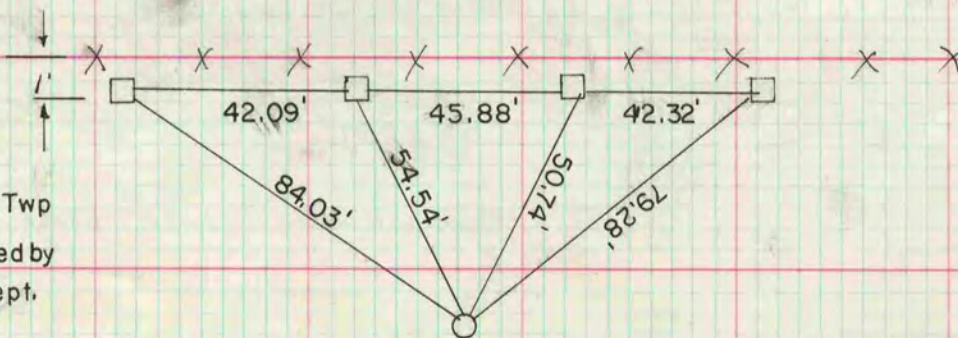

□ = conc. mon. with brass cap