

MICROFILMED

PLAT AND RECORD

Of a Survey on Section 1 T 4 R 11 E. of the 4 P. M. in Porter Township

Rock County, Wisconsin, made November the 11th 1886

I hereby certify that the following is a correct record of said survey as made by me.

(Signed) Edward Ruger

R. H. B

County Surveyor.

COUNTY BUILDING
CITY OF JANESVILLE

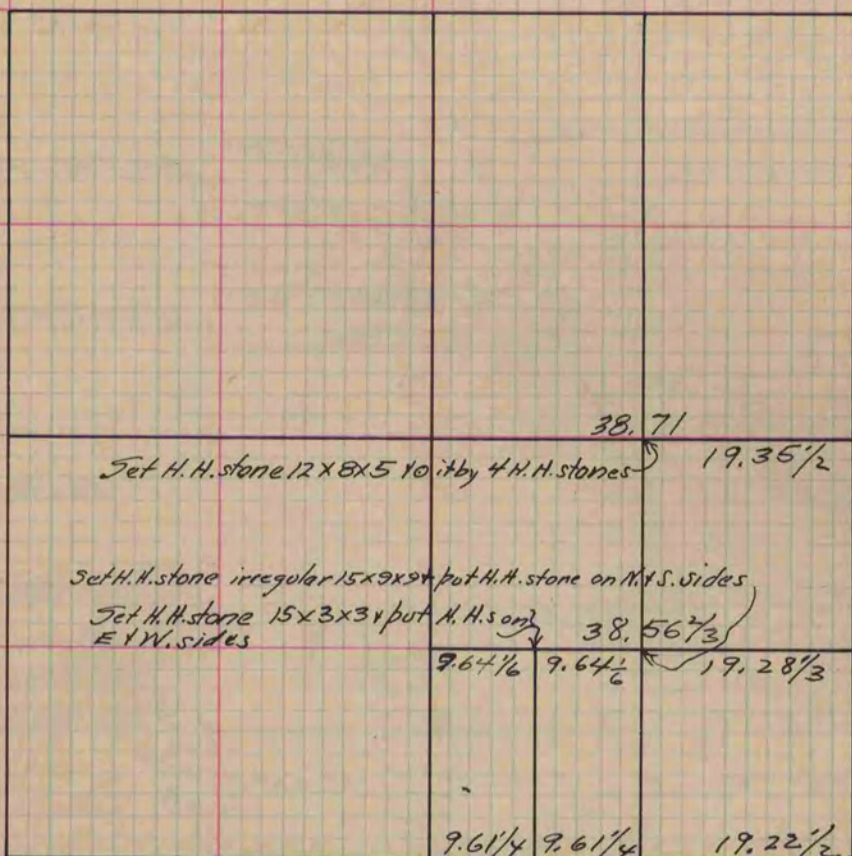

Found limestone set by self in former Survey

Set limestone 16x11x2 1/4 + 0 ft by 4 H.H. stones

Found limestone 0 by 4 H.H. stones

Set stake deep & put on top of it sand stone 11x7x2 1/2 + 0 ft by 4 H.H. stones

Set H.H. stone 18x12x4 ft by 4 H.H. stones

(For further survey on Sec. 1. Porter Sec page 86)

Copied from P. 236 Vol. 2. County Surveyors Record.