

PLAT AND RECORD

VOL. 5

Of a Survey on Section **33** T **3** R **13** E. of the 4 P. M. in **HARMONY** Township

Rock County, Wisconsin, made **APRIL** the **15** 19 **77**

I hereby certify that the following is a correct record of said survey as made by me.

**COUNTY BUILDING
CITY OF JANESVILLE**

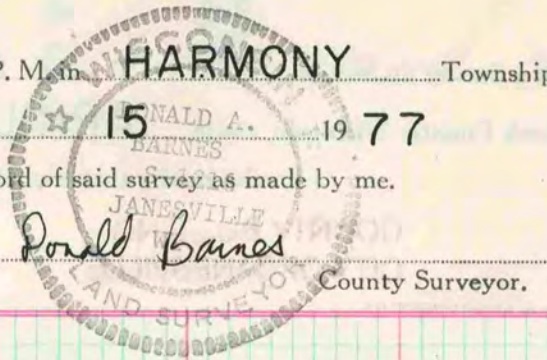

E 1/4 COR SEC 33 T3N R13E

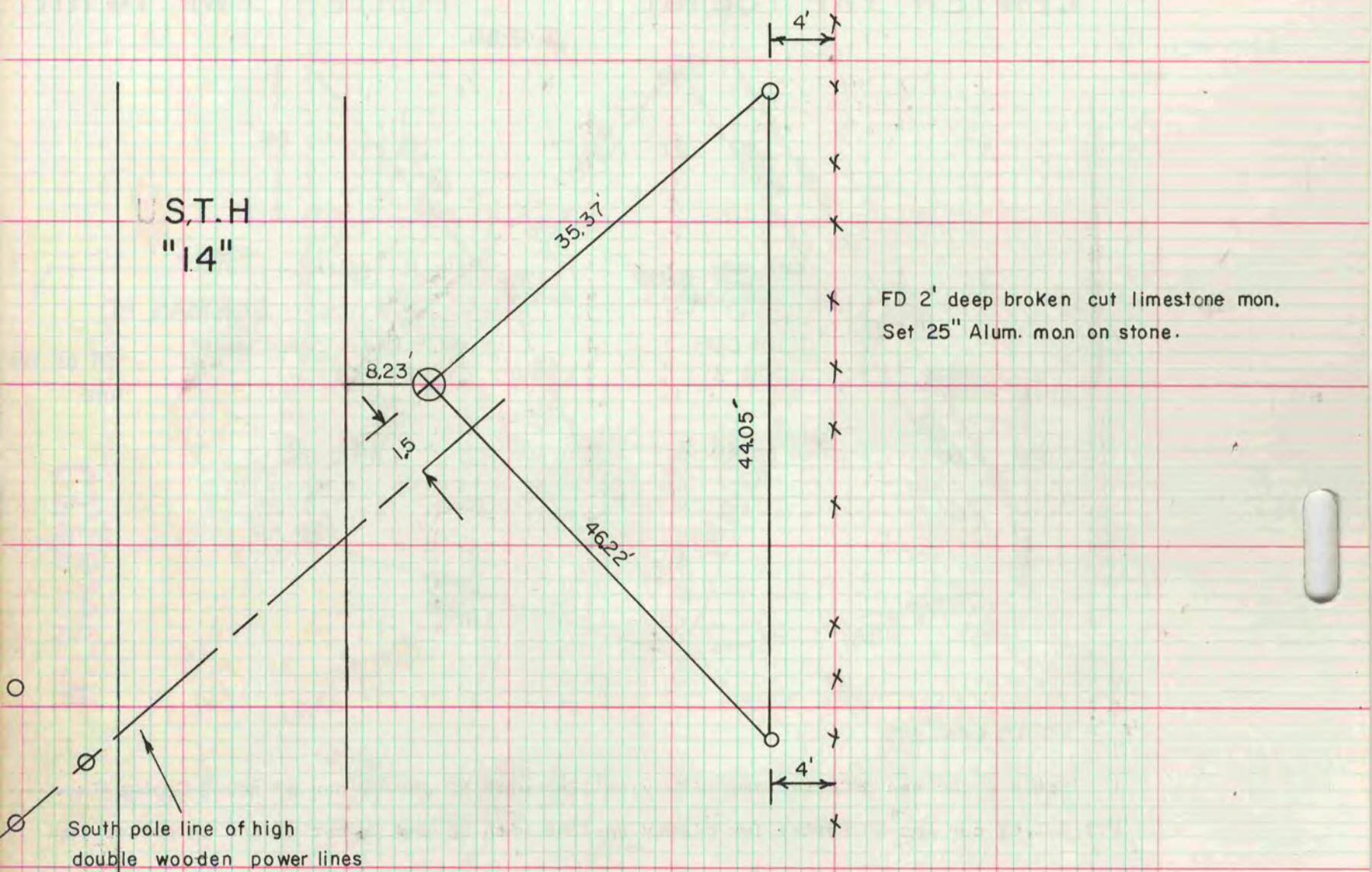

FD 2' deep broken cut limestone mon.
Set 25" Alum. mon on stone.

O G-1 MON WITH CAP



516
S 1/16 COR OF THE NE 1/4 OF SEC 33
WAS SET BY H. COMBS. HE SET A
1" I.P. 18" DEEP

MICROFILMED