

PLAT AND RECORD

505
VOL. 5

Of a Survey on Section **23, 21** T. **2** R. **12** E. of the 4 P. M. in **ROCK** Township
Rock County, Wisconsin, made **NOV** the **30** 19 **78**

I hereby certify that the following is a correct record of said survey as made by me.

COUNTY BUILDING
CITY OF JANESVILLE

County Surveyor.

S 1/4 COR SEC 23

MON BOX & IP WAS DESTROYED BY CONSTRUCTION.
SET ALUM MON

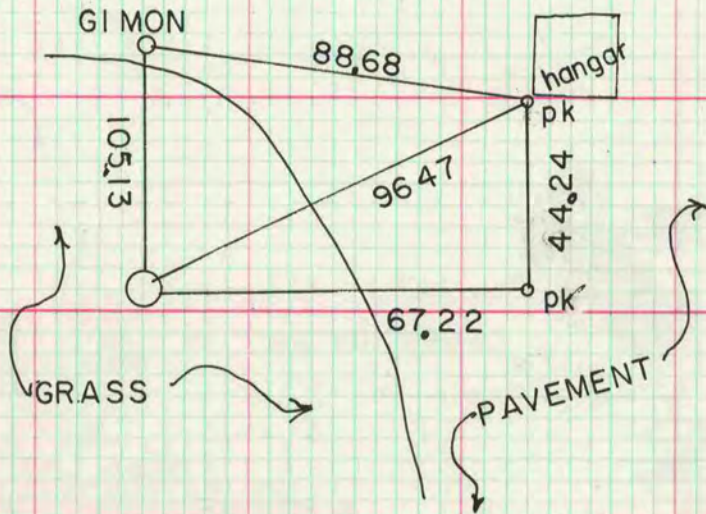

S 1/4 COR SEC 21

ALL THE RECORDED SURVEYS EXCEPT ONE, USED THE CARPENTERS NAIL.
SET ALUM MON AT THE CARPENTER'S NAIL. REMOVED THE CAST IRON MON.

ALUM MON IS ON TOP OF STONE FIELD BOOK 1
Page 24
6/26/86
DAB

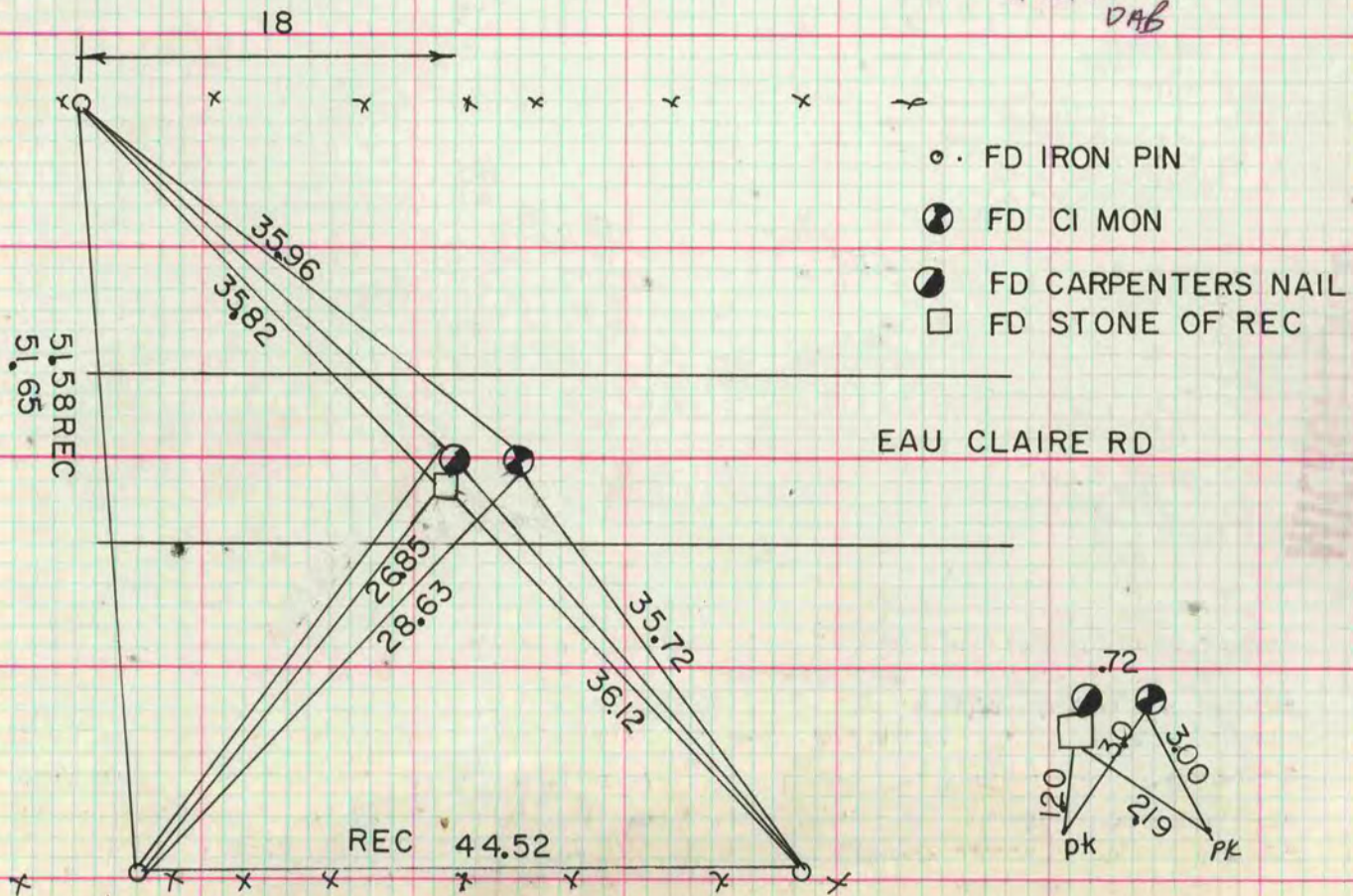

MICROFILMED