

MICROFILMED

# PLAT AND RECORD

31  
VI

Of a Survey on Section 30 T 2 R 12 E. of the 4 P. M. in Rock Township  
Rock County, Wisconsin, made April the 6th 1855

I hereby certify that the following is a correct record of said survey as made by me.

COUNTY BUILDING  
CITY OF JANESVILLE

(Signed) Joseph Church

R.H.B. County Surveyor.

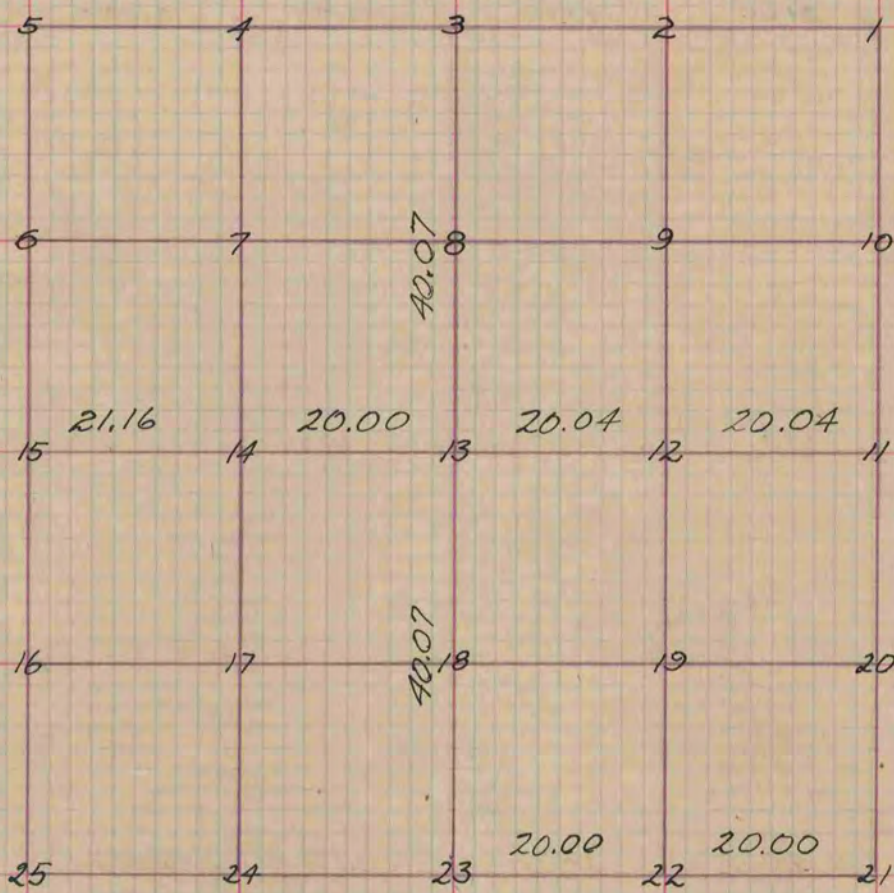

Fig	13	W.O.	12	N 35 1/4 W.	85	links
"	12	Black O		N 55 E	76	"
"	14	Bur O		N 10 1/2 E.	106	"
"	"	W. O		S 8 1/2 W.	144	"
"	22	W. O.		S 55 E	113	"
"	"	Bl. O.		S. 66 W.	190	"

Copied from Page 32 Vol. Original County Surveyors Record