

Of a Survey on Section 14 T 3 R 12 E. of the 4 P. M. in JANESVILLE Township
Rock County, Wisconsin, made OCTOBER 24 1977

I hereby certify that the following is a correct record of said survey as made by me.

COUNTY BUILDING
CITY OF JANESVILLE



NE COR SEC 14

FD 2" IP & 1" IP ON N EDGE OF 2" IP. SET ALUMMON

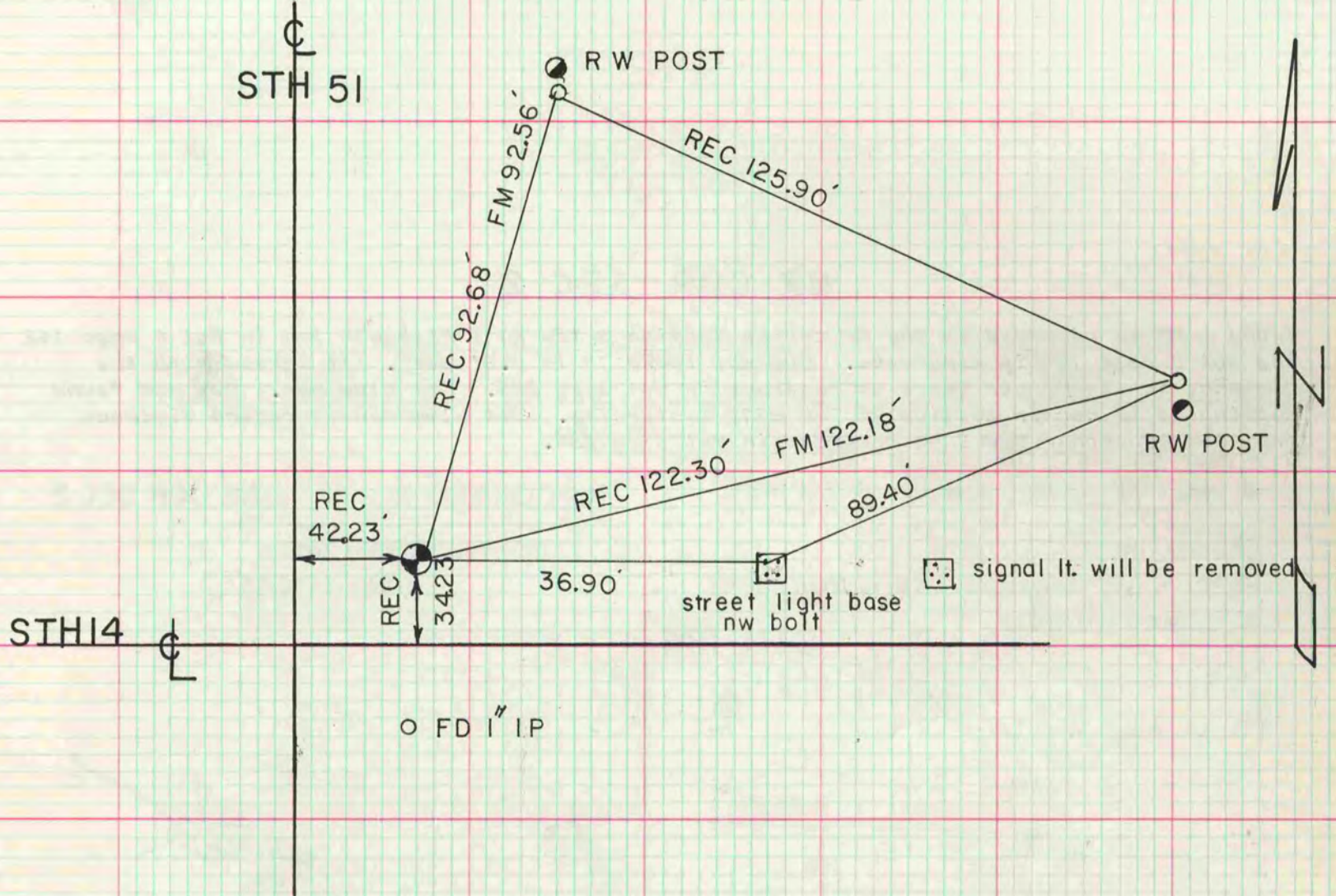

MICROFILMED