

PLAT AND RECORD

376

VOL. 5

Of a Survey on Section 6 T 4 R 13 E. of the 4 P. M. in MILTON Township
Rock County, Wisconsin, made NOV the 23 1977

I hereby certify that the following is a correct record of said survey as made by me.

COUNTY BUILDING
CITY OF JANESVILLE



W1/4 COR SEC 6 T4 R13E

FD. CONC. NAIL 0.3' DEEP

DID NOT DIG OR SET MON BECAUSE OF HAZARDOUS DRIVING CONDITIONS
0.1" I.P.

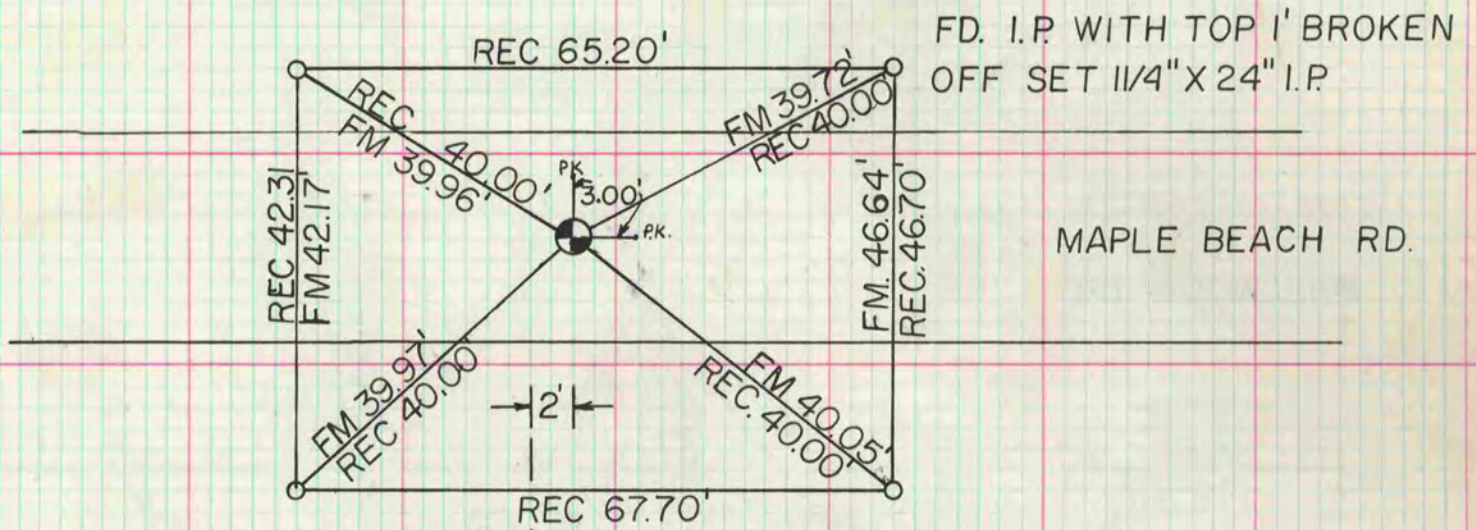

NOTE: ALL I.P. WERE 0.5' ABOVE GD. THE I.P. WERE DRIVEN FLUSH WITH THE GROUND WHEN REFERENCED



MICROFILMED