

MICROFILMED

PLAT AND RECORD

67
✓-1

Of a Survey on Section 18 T 2 R 11 E. of the 4 P. M. in Plymouth Township
Rock County, Wisconsin, made March the 19th 1857

I hereby certify that the following is a correct record of said survey as made by me.

COUNTY BUILDING
CITY OF JANESVILLE

(Signed) Joseph Church
R.H.B. County Surveyor.

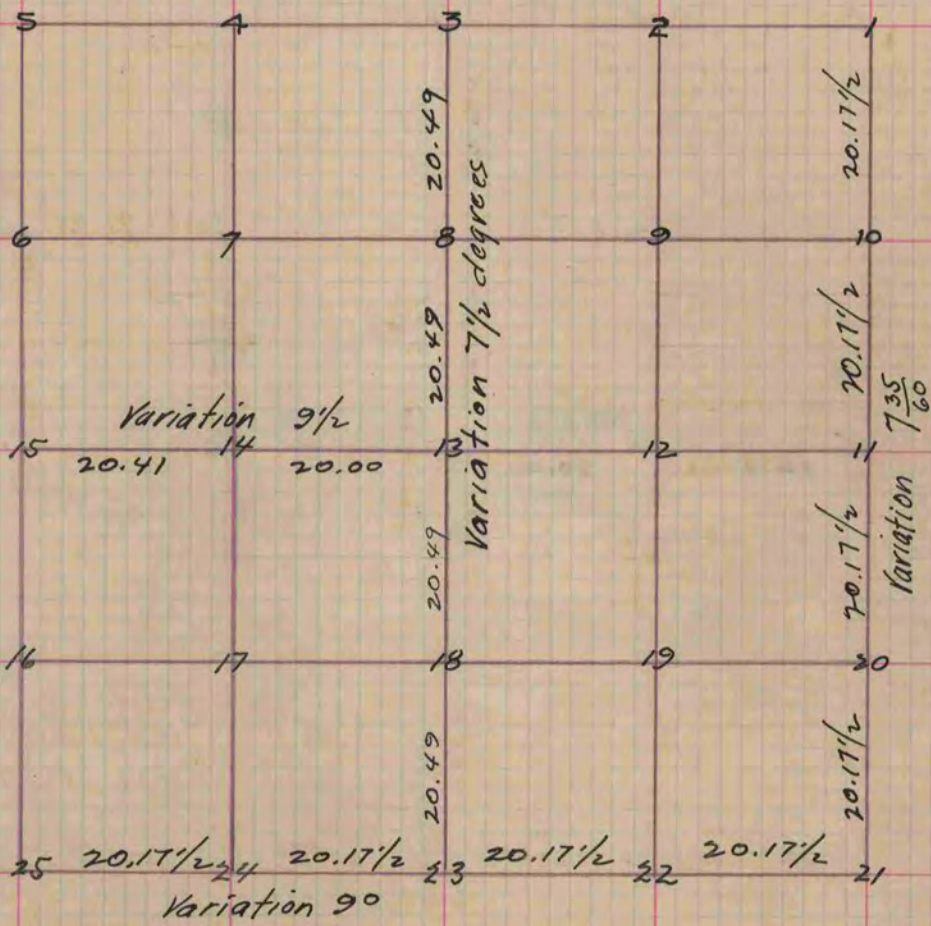

Fig 13 Stake and Stone in Marsh
 8 " " "
 3 " " "
 2 " " "
 19 Stake no bearings
 18 Br. O. 8. S. 4 1/2 W. 139
 Red. O. 12 N. 1 W. 311
 Wit. to Corner 91 links on the line West of Fig 14
 Br. O. 105 30 1/2 E. 28
 Bl. O. 14 N 74 1/2 E. 49
 Fig. 17 Br. O. 13 W 58 1/4 E 130
 W. O. 14 N 6 W 167 V. 7 1/2 Degrees

Copied from Page 68 Vol. 1. Original County Surveyors Record