

# MICROFILMED PLAT AND RECORD

Of a Survey on Section 14 T 2 R 11 E. of the 4 P. M. in Plymouth Township  
Rock County, Wisconsin, made April the 23rd & 24th 1856

I hereby certify that the following is a correct record of said survey as made by me.

COUNTY BUILDING  
CITY OF JANESVILLE

(Signed) Joseph Church  
R.H.B. County Surveyor.

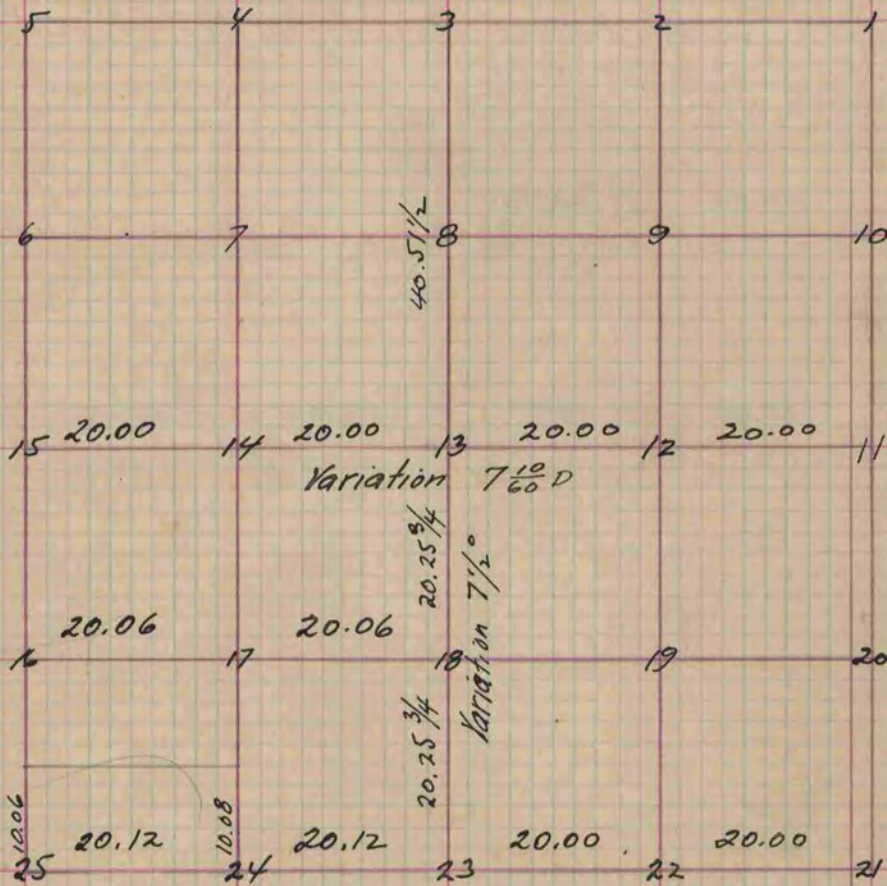

- Fig 13 Stone hard 15 long 9 thick & 9 wide  
Wit. to stone W.O. 30 S. 4 1/2 E. 215 links Variation 7 1/2°
- " 23 Found Stumps Corresponding with field notes mostly decayed  
took new trees Bl. O. 18 S 8 1/2 E 80 links  
W. O. 30 N 88° W. 111
- " 12 In the marsh Stone 18 inches long 10 inches wide & 4 inches thick
- " 19 Br. O. 24 S 48 1/4 E 79 links
- " 18 Br. O. 12 N 4 1/4 E 165 links  
Bl. O. 8 N 40 W 84 1/2 links
- " 25 Wit. trees incorrect found stake from tree marked bearing  
S. 47 W 180 links & a tree bearing S 29 E 187  
Government field notes Calls for the stake for one tree S 29 E 107 links  
the other S. 4 W 120 links

See P. 35

Copied from Page 65 Vol. 1 Original County Surveyors Record.