

MICROFILMED PLAT AND RECORD

Of a Survey on Section 12 T 4 R 11 E. of the 4 P. M. in Porter Township
Rock County, Wisconsin, made November the 8 1871

I hereby certify that the following is a correct record of said survey as made by me.

COUNTY BUILDING
CITY OF JANESVILLE

(Signed) Edward Ruger
R.H.B. County Surveyor.

Found old stake & H.H. stone
at corner, drive stake
deep & put on top of it
H.H. stone 16x8x7 & @ it
with H.H. & sandstones.

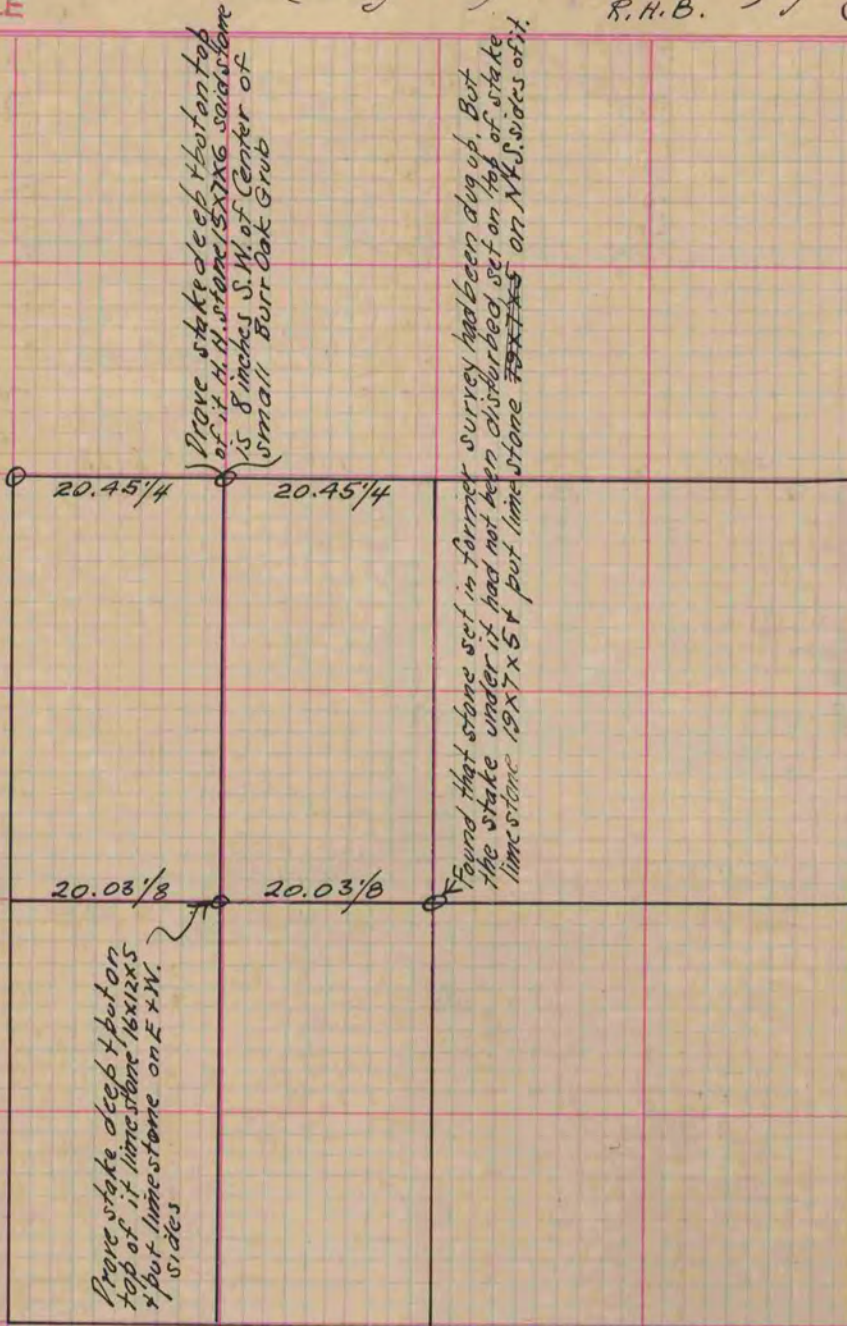

See Section 12 Porter Page 39

Copied from Page 46 Vol. 2 Original County Surveyors Record