

MICROFILMED

PLAT AND RECORD

Of a Survey on Section 19 T 2 R 10 E. of the 4 P. M. in Spring valley Township
Rock County, Wisconsin, made June the 28th & 29th 1869

I hereby certify that the following is a correct record of said survey as made by me.

COUNTY BUILDING
CITY OF JANESVILLE

(Signed) R. K. Lee
R. H. B. Dep. County Surveyor.

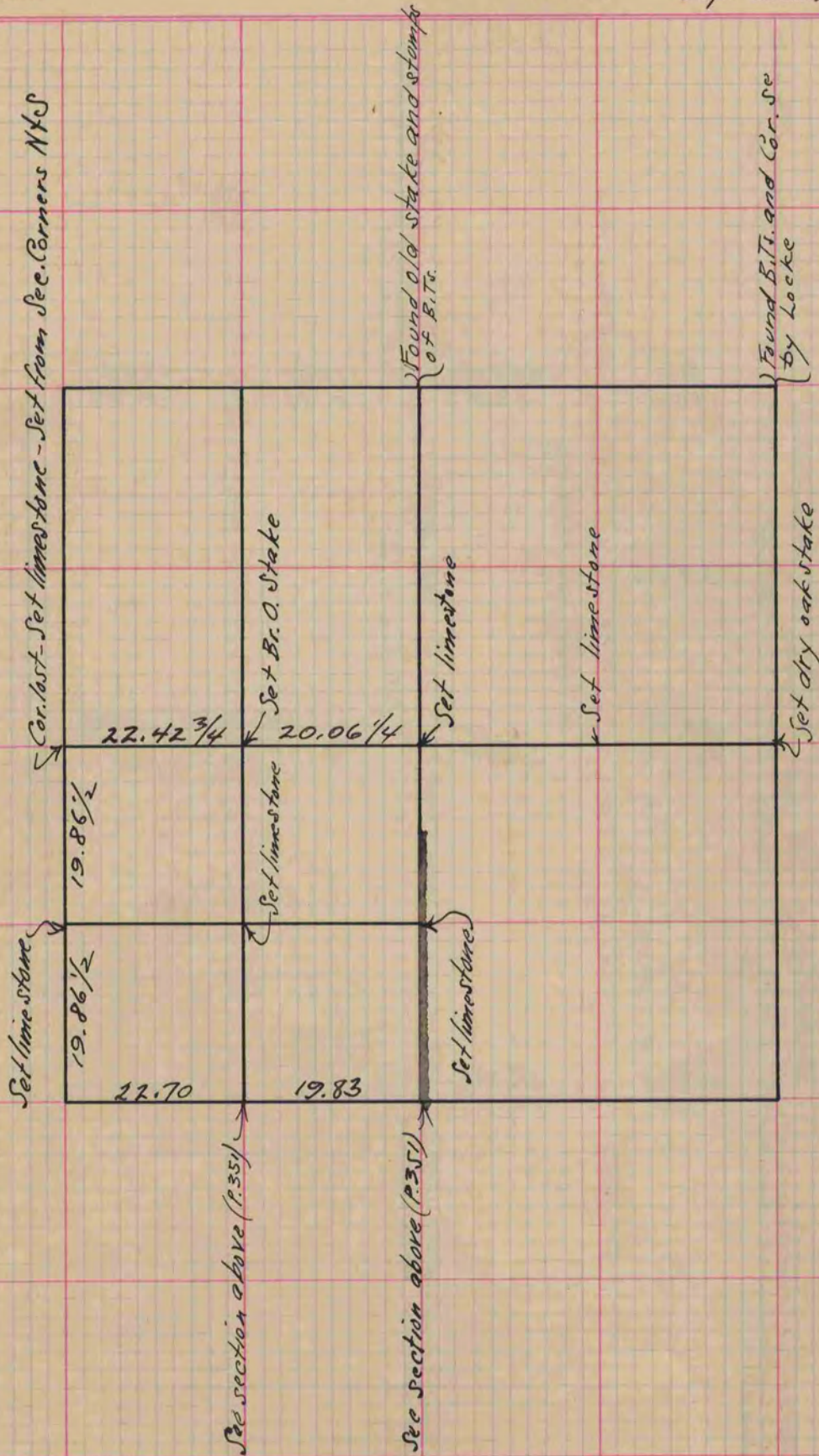

Copied from Page 283 Vol. 1. Original County Surveyors Record