

# MICROFILMED PLAT AND RECORD

51  
✓

Of a Survey on Section 3 T 1 R 14 E. of the 4 P. M. in Clinton Township  
Rock County, Wisconsin, made September the 20<sup>th</sup> 1855

I hereby certify that the following is a correct record of said survey as made by me.

COUNTY BUILDING  
CITY OF JANESVILLE

(Signed) Joseph Church  
J.H.B. County Surveyor.

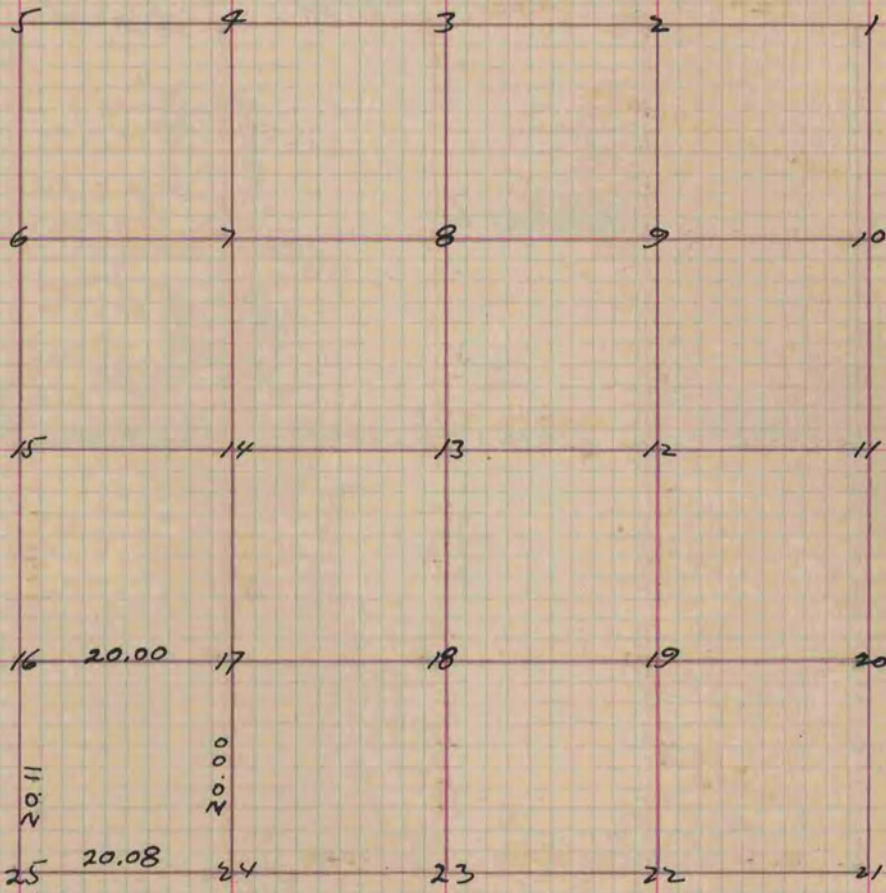

Fig 16-17-24 & 25 stakes & stones fixed in the ground  
16 + 25 is 50 links East of the Centre of the highway.

Copied from Page 52 Vol. 1. Original County Surveyors Record