

# PLAT AND RECORD

**MICROFILMED**

Of a Survey on Section 35 T 2 R 14 E. of the 4 P. M. in Bradford Township

Rock County, Wisconsin, made October the 3<sup>rd</sup> & 4<sup>th</sup> 1859

I hereby certify that the following is a correct record of said survey as made by me.

COUNTY BUILDING  
CITY OF JANESVILLE

(Signed) Edward Ruger  
R.H.D.

County Surveyor.

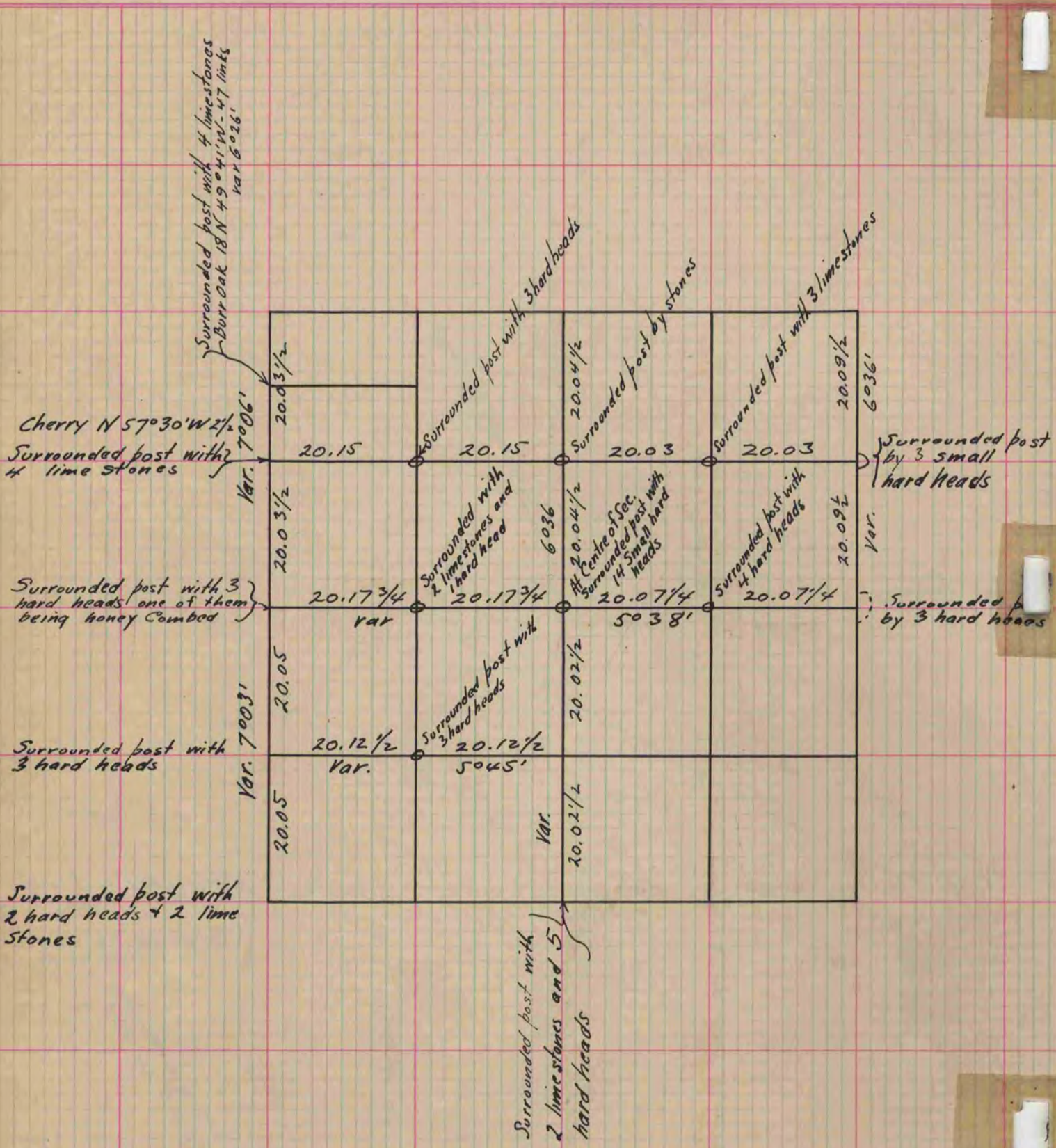

Copied from Page 121 Vol One Original County Surveyors Record