

U.S. PUBLIC LAND SURVEY MONUMENT RECORD

For Public Land Survey Corners In:

WI ADMINISTRATIVE CODE A-E 7.08 REQUIREMENT

T. 4 N. R. 14 E.

CORNER CODE INDEX

1	2	3	4	5	6	7	8	9	10	11	12	13	14	15	16	17	18	19	20	21	22	23	24	25	
A																									A
B																									B
C																									C
D																									D
E																									E
F																									F
G																									G
H																									H
I																									I
J																									J
K																									K
L																									L
M																									M
N																									N
O																									O
P																									P
Q																									Q
R																									R
S																									S
T																									T
U																									U
V																									V
W																									W
X																									X
Y																									Y
Z																									Z

LIMA TWP

ROCK COUNTY WI

IF AVAILABLE
ROCK COUNTY COORDINATES PREFERRED

North _____ Elev. _____

East _____

Hor. Datum _____ Vert. Datum _____

LATITUDE _____ ELLIPS. HT. _____

LONGITUDE _____

GPS (X) _____ TRAVERSE (X) _____

BASED ON THE FOLLOWING CONTROL:

PLACE MONUMENT SYMBOL AT PROPER LOCATION ON ABOVE INDEX

CORNER MONUMENT

WITNESS MONUMENT

BEARINGS ARE BASED ON: (a) _____

FIELD BOOK _____ PAGE # _____

SHEET 1 OF 2

SHOW A PLAN VIEW DRAWING DEPICTING THE CORNER MONUMENT AND SURROUNDING PHYSICAL FEATURES, INCLUDING THE EXCAVATION AREA AND DEPTH.

PLANNING & ZONING COMMITTEE ADOPTED THE ABOVE FORM ON 12/2/1982

CORNER CODE V-5(3)

LI603

(B) Describe any record evidence, monument evidence, occupational evidence, testimonial evidence or any other material evidence you considered, and whether the monument was found or placed.

- 1871 RUGER VOL 2-80 FD STUMP OF SE BT & WHERE STUMP OF NW BT HAD BEEN DUG UP. DROVE STAKE SURROUNDED IT WITH 2 HH & 2 L.S. VAR 4-35 2437.88 FROM S ¼ COR SEC 30 TO SW COR SEC 30 & VAR 4-35 2644.12 FROM S ¼ COR 30 TO SE COR SEC 30.
- 1973 LEE VOL 5-25 TIES STATES NOTHING ABOUT MON. COR IS 2' NORTH OF CENTER OF PVMT.
- 1982 BARNES TWP PROJECT MAP & FIELD NOTES. FD PK S1-09-38E 2652.29 TO E ¼ COR SEC 31, N1-23-00W 2648.43 TO E ¼ COR SEC 30, N89-52-00W 2444.35 FROM S ¼ COR SEC 30 TO SW COR SEC 30, S89-39-27E 2656.36 FROM S ¼ COR SEC 30 TO SE COR SEC 30, & S88-14-56E 2648.27 TO S ¼ COR SEC 32.
- 1982 BARNES V-5 FD 1973 TIES & SET PK @ CENTER OF PVMT. (TIES DESTROYED BY RD. CONSTRUCTION.
- 1983 WIDOT STH59 R/W PLANS PROJECT #3143-00-21 SHEET 4.9 PK NAIL 283,364.37; 2,301,452.14 S1-4950W 2652.03 TO E ¼ COR SEC 31.
- 1985 WIDOT V-5(1) TIES FOR SEC COR. CALLS FOR STA 247+29.42 1.86' (LT). NOTES PK & AT LOWER RT HAND CORNER-SEC COR REF.
- 1993 BARNES V-5(2) FD PK 2.7' NORTH OF CENTER PVMT. & WIDOT TIES. SHOWS DOT REF. LINE & 2648.23 TO E ¼ COR SEC 30. PK WILL BE DESTROYED WITHIN A YEAR. ALSO PLACED TIES.

IN SEP 2001 PRIOR TO CONSTRUCTION FD PK & TIES. PK WILL BE DESTROYED WITHIN MONTHS. IN APR 2002 FD TIES & SET STEEL SURVEY SPIKE WITH THE FOLLOWING CAPTION ON TOP "SURVEY MARK" AT CORNER. USED RECORD DISTANCES TO TIES.

C) Was the corner restored through acceptance of (1) an obliterated evidence location, or, (2) a found perpetuated location?

ACCEPTED PERPETUATED LOCATION

D) Describe any material discrepancy between the location of the corner as restored or reestablished and the location of that corner as previously restored or reestablished by distance and direction. Show the discrepancy on the plan view drawing under (a), above. Show the distances between the corner as previously restored or reestablished and (1) the corner as restored or reestablished, and (2) to at least 4 of the witness monuments shown on the drawing in (a), above.

(E) Was the corner reestablished through lost corner proportionate methods? If so, show the method, including the directions and distances to other public land survey corners used as evidence or used for proportioning the corner location.

I, Donald Barnes, hereby certify that the corner location as identified by the corner code index was determined by me under my direction and control and that this U.S. Public Land Survey Monument Record is correct and complete to the best of my knowledge and belief.

Seal

Donald Barnes
Emboss

5/31/02

SHEET 1 OF 2

CORNER CODE V-5(3)

A.E. 7.08 REQUIREMENT

REC WIDDT 247+29.42
 1.86' (LT) PK
 WIDDT S1-49-50E 1.86

REC WIDDT P1
 COMPUTED
 STA 234+97.67
 2000

STA- 654.72
 S89-16-03E 654.79

STA- 1231.75
 S89-24-44E 1231.62

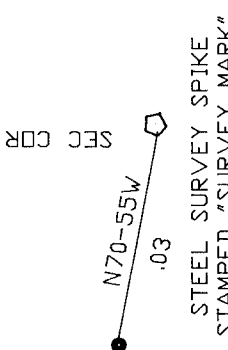
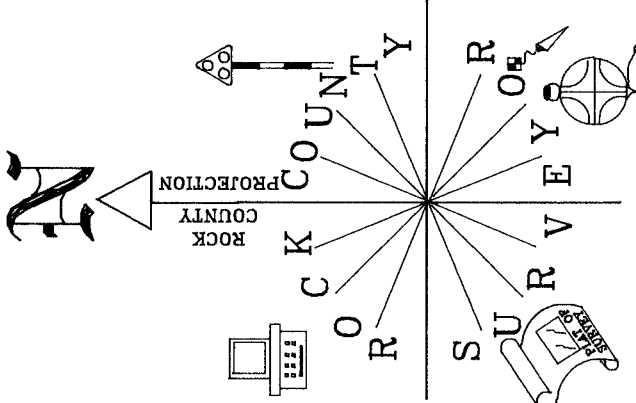

- FD. PK 9/28/2001
- WIDDT SIGN
- FD WIDDT PIN/CAP
- FD REROD/CAP
- △ FD REROD DISTURBED



REC S86-42-11E 16.86
 REC S86-41-08E 16.86
 REC 16.86

REC S3-59-52W 98.06
 S4-01-43E 98.06

REC N89-09-52E 22.79
 N89-08-00E 22.80
 REC 22.79

S88-33-09E 57.45
 REC S88-31-03E 57.45

S4-23-02E 47.10
 WIDDT 47.12
 PK 47.09

1993 S4-23-42W 47.11
 1993 S4-23-42W 47.11
 PK 50.39
 1993 S22-21-10W 66.61
 S22-23-00E 50.42

1993 S56-33-22E 83.67
 S56-31-22E 83.66
 S61-27-14E 98.64
 S61-28-52E 98.64
 PK 98.60

1993 S56-33-22E 83.67
 S56-31-22E 83.66
 S61-27-14E 98.64
 S61-28-52E 98.64
 PK 98.60

STH 59

16' REF LINE
 REC 1.86
 REC 1.89

NE COR
 SEC 31
 LIMA TWP

S4-48-29E 108.48
 REC S4-47-01W 108.48
 REC 108.48

S83-42-11E 368.09
 WIDDT DISK

1993 S48-13-15E 94.03
 S48-15-02E 93.98
 PK 94.03

REC 42-37-38E 35.13
 N42-18-54E PK 35.32
 REC 42-37-38E 35.13
 XXXXXXXXXXXXXXX

1993 N57-34-51E 94.54
 PK 94.54
 REC 19.117
 N66-16-11E REC C 19.128

REC S85-26-52E 150.37
 S85-28-37E 150.37
 REC 150.37

EMBOSSED SEAL

Donald Barnes
 May 31 2002

V-5(3)