

COUNTY BUILDING  
CITY OF JANESVILLE

Of a Survey on Section 22 T 4 R 10 E. of the 4 P. M. in UNION Township  
Rock County, Wisconsin, made October 19 1977

I hereby certify that the following is a correct record of said survey as made by me.

COUNTY  
CITY OF JANESVILLE



County Surveyor.

S 1/4 COR. SEC. 22 T4 R10 E

Dug hole 3X6 3' deep and found nothing. Set corner by using B.J. Sunny's survey of 1959. This agreed with the occupation lines of Holy Cross Cemetery. Holy Cross Cemetery was surveyed by Alex Ely in 1921 and recorded in County Surveyors Records VOL 3 Pg 108.

- FD 1 1/4" I.P.
- 1"/24" I.P.
- SET ALUM MON

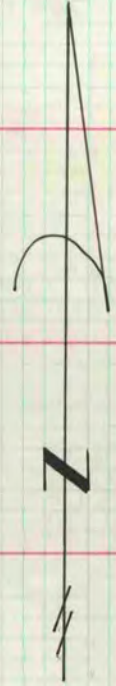
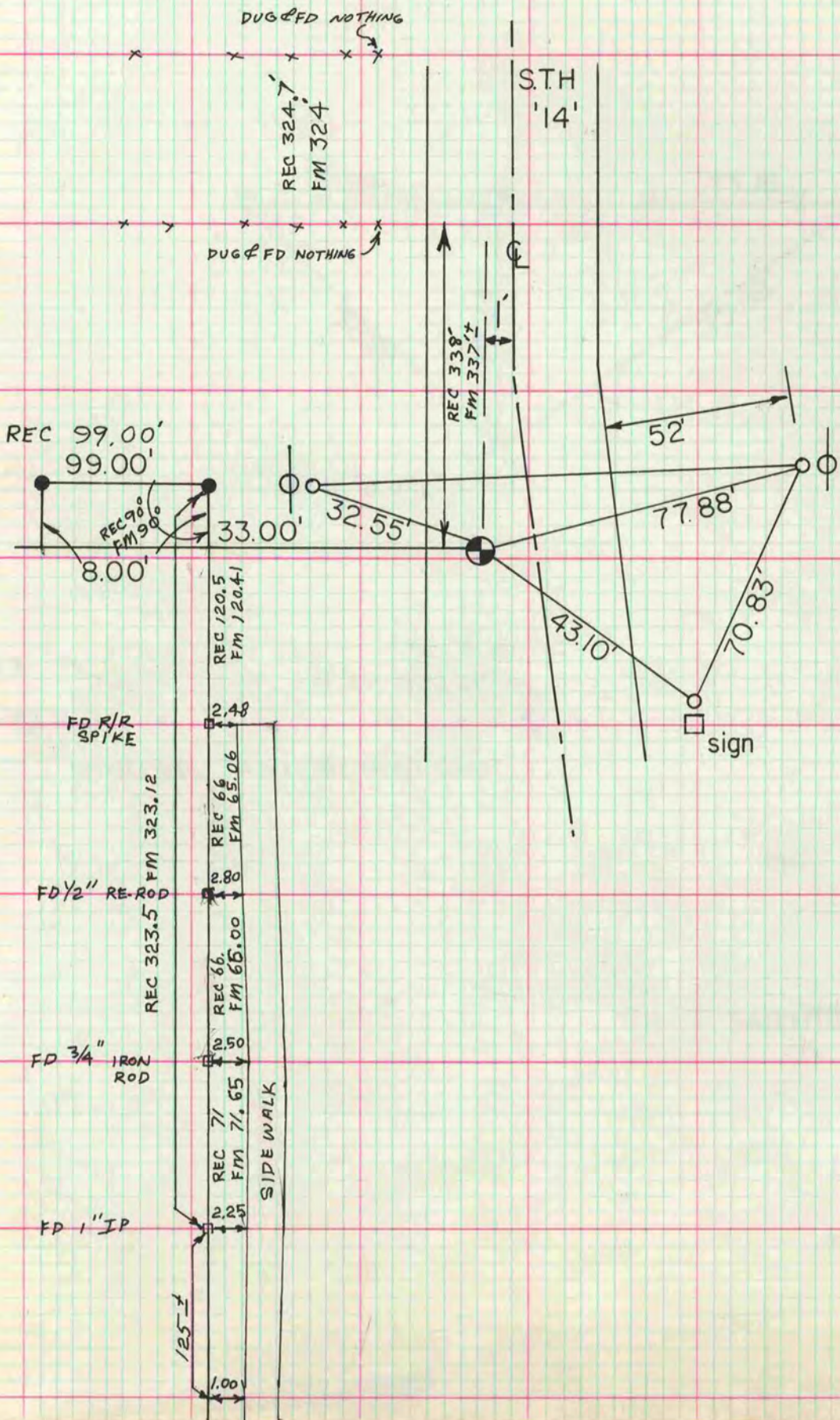

MICROFILMED